

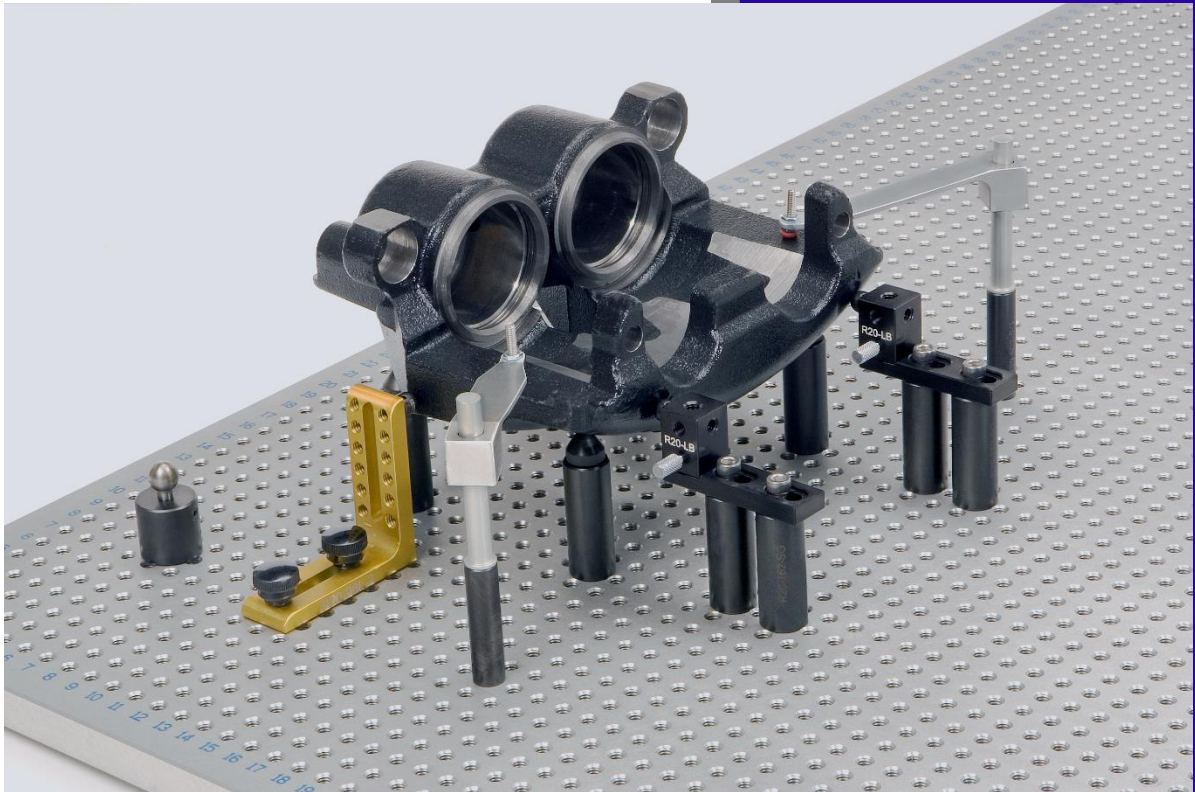

Catalog 17.1



MICRON MEASUREMENT TECHNOLOGY

Authorized Distributor

For price quotes, lead times, or questions regarding custom-made CMM and VMM fixture plates and accessories, please contact:

Phone: (828) 391-9710

Email: support@micronmeasurement.com

Website: www.MicronMeasurement.com

Business Hours:

Monday – Thursday: 9:00 AM – 4:30 PM EST

Friday – Sunday: Closed

Serving Industrial, Manufacturing, and Quality Control Professionals

TABLE OF CONTENTS

FIXTURE PLATES

| | |
|------------------------|---|
| Aluminum | 1 |
| Steel | 2 |
| Round | 3 |
| Vision Plates & RVFL's | 4 |

CUSTOM FIXTURES

5

METROLOGY TABLES

6

COMPONENT KITS

| | |
|------------------------|-------|
| Standard Clamping Kits | 7-10 |
| Magnetic Clamping Kits | 11-14 |
| Vacuum Kits | 15-17 |
| Vision Kits | 18-20 |

ACCESSORIES & COMPONENTS

21-38

ALUMINUM EXTRUSION KITS & COMPONENTS

| | |
|---------------|-------|
| AX Kits | 39 |
| AX Components | 40-41 |



Aluminum Fixture Plates

Our Standard Cast Aluminum Plates are protected with a clear hard lube anodize with engraved numbers in the X-axis and letters in the Y-axis.

- Customize your plate size, hole spacing and thread type.
- Mounting Holes and fasteners are included at no added cost.

1/4-20 Thread

| Part Number | Length | Width | Thickness | Hole Spacing |
|---------------|--------|-------|-----------|--------------|
| R20-66375-50 | 6" | 6" | .375" | 1/2" |
| R20-121250-50 | 12" | 12" | 1/2" | 1/2" |
| R20-151550-50 | 15" | 15" | 1/2" | 1/2" |
| R20-181850-50 | 18" | 18" | 1/2" | 1/2" |
| R20-242450-50 | 24" | 24" | 1/2" | 1/2" |
| R20-242475-50 | 24" | 24" | 3/4" | 1/2" |
| R20-284075-50 | 28" | 40" | 3/4" | 1/2" |
| R20-303075-50 | 30" | 30" | 3/4" | 1/2" |

M8 Thread

| Part Number | Length | Width | Thickness | Hole Spacing |
|----------------|--------|--------|-----------|--------------|
| R8-30030013-15 | 300 mm | 300 mm | 13 mm | 15 mm |
| R8-45045013-15 | 450 mm | 450 mm | 13 mm | 15 mm |
| R8-60060013-15 | 600 mm | 600 mm | 13 mm | 15 mm |
| R8-60060019-15 | 600 mm | 600 mm | 19 mm | 15 mm |
| R8-75075019-15 | 750 mm | 750 mm | 19 mm | 15 mm |

M6 Thread

| Part Number | Length | Width | Thickness | Hole Spacing |
|----------------|--------|--------|-----------|--------------|
| R6-30030013-15 | 300 mm | 300 mm | 13 mm | 15 mm |
| R6-45045013-15 | 450 mm | 450 mm | 13 mm | 15 mm |
| R6-60060013-15 | 600 mm | 600 mm | 13 mm | 15 mm |
| R6-60060019-15 | 600 mm | 600 mm | 19 mm | 15 mm |

M4 Thread

| Part Number | Length | Width | Thickness | Hole Spacing |
|----------------|--------|--------|-----------|--------------|
| R4-15015010-10 | 150 mm | 150 mm | 10 mm | 10 mm |

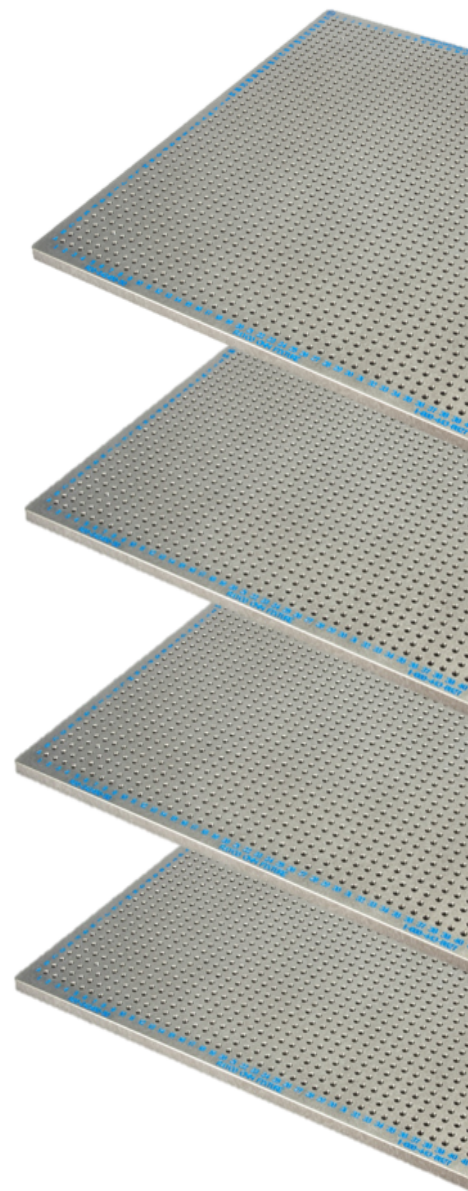

Steel Fixture Plates

Our Steel Fixture Plates are hardened to 28/32 RC for durability and have a Black Oxide Coating with engraved numbers in the X-axis and letters in the Y-axis.

- Customize your plate size, hole spacing and thread type.
- Mounting Holes and Fasteners are included at no added cost.

1/4-20 Thread

| Part Number | Length | Width | Thickness | Hole Spacing |
|-----------------|--------|-------|-----------|--------------|
| R20-181875-50-S | 18" | 18" | 3/4" | 1/2" |
| R20-242475-50-S | 24" | 24" | 3/4" | 1/2" |
| R20-30301-50-S | 30" | 30" | 1" | 1/2" |

M8 Thread

| Part Number | Length | Width | Thickness | Hole Spacing |
|------------------|--------|--------|-----------|--------------|
| R8-45045019-15-S | 450 mm | 450 mm | 19 mm | 15 mm |
| R8-60060019-15-S | 600 mm | 600 mm | 19 mm | 15 mm |
| R8-75075025-15-S | 750 mm | 750 mm | 25 mm | 15 mm |

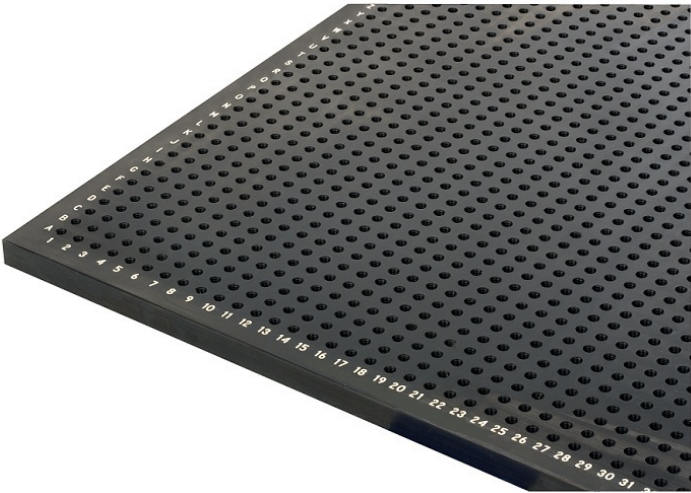

Round Fixture Plates

Our Round Fixture plates are protected with a clear hard lube anodize with engraved numbers in the X-axis and Letters in the Y-axis through the diameter of the plate.

- Customize your plate size, hole spacing and thread type.
- Mounting Holes and Fasteners are included at no added cost.
- Rotational Base Upon Request.

1/4-20 Thread

| Park Number | Diameter | Thickness | Hole Spacing |
|----------------|----------|-----------|--------------|
| R20-650-50-RR | 6" | 1/2" | 1/2" |
| R20-850-50-RR | 8" | 1/2" | 1/2" |
| R20-1850-50-RR | 18" | 1/2" | 1/2" |
| R20-2475-50-RR | 24" | 3/4" | 1/2" |

M8 Thread

| Park Number | Diameter | Thickness | Hole Spacing |
|----------------|----------|-----------|--------------|
| R8-30013-15-RR | 300 mm | 13 mm | 15 mm |
| R8-45013-15-RR | 450 mm | 13 mm | 15 mm |
| R8-60019-15-RR | 600 mm | 19 mm | 15 mm |
| R8-90019-15-RR | 900 mm | 19 mm | 15 mm |

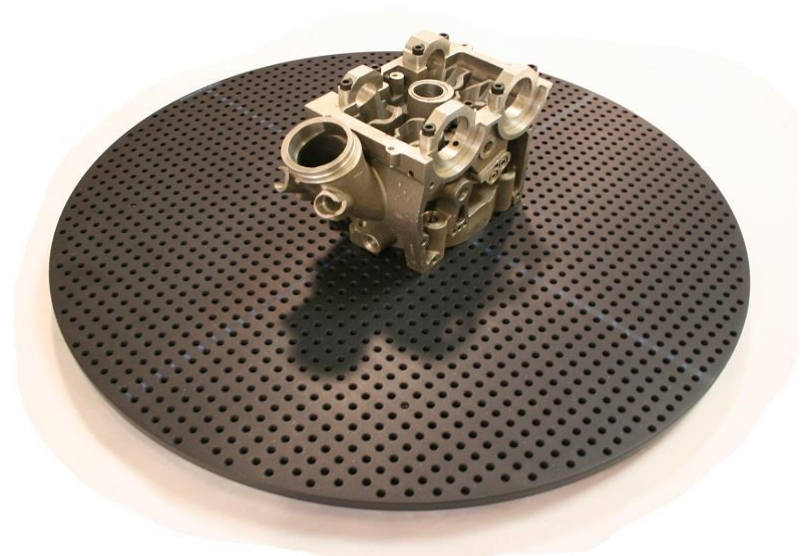
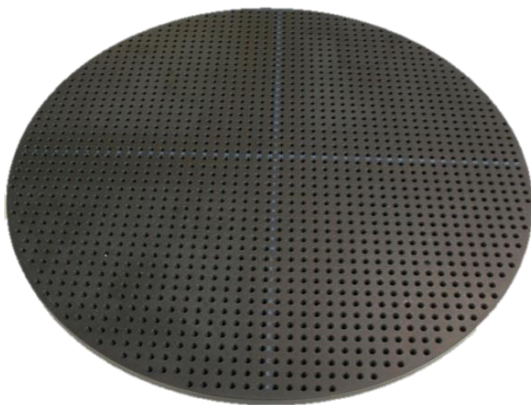

Vision Plates & RVFL's

Rayco Acrylic Plates are made from optical grade acrylic with engraved numbers in the X-Axis and letters in the Y-Axis. Steel edge inserts are added to each plate to work with our magnetic RVFL system. The RVFL mounts to the outer stage of your vision machine and allows for a quick plate change.

- Customize your plate size, hole spacing and thread type.
- Viewing Window to Customer specifications
- Full Frame Fixtures Available Upon Request

1/4-20 Thread

| Part Number | Length | Width | Thickness | Hole Spacing |
|----------------|--------|-------|-----------|--------------|
| RA20-060650-50 | 6" | 6" | 1/2" | 1/2" |
| RA20-121275-50 | 12" | 12" | 3/4" | 1/2" |
| RA20-140975-50 | 14" | 9" | 3/4" | 1/2" |

M4 Thread

| Part Number | Length | Width | Thickness | Hole Spacing |
|-----------------|--------|--------|-----------|--------------|
| RA4-15015013-10 | 150 mm | 150 mm | 13 mm | 10 mm |
| RA4-30030019-15 | 300 mm | 300 mm | 19 mm | 15 mm |
| RA4-40040019-15 | 400 mm | 400 mm | 19 mm | 15 mm |

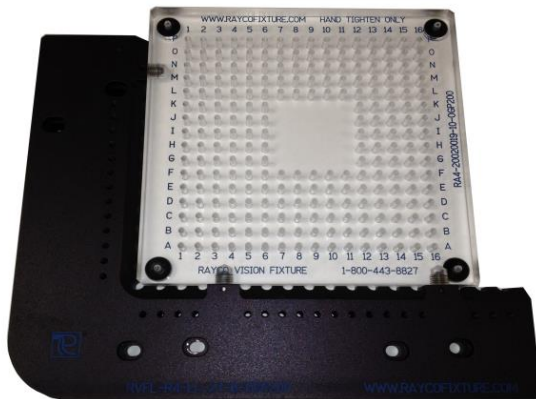

Rayco Vision Fixture Locator (RVFL)

| Part Number | Plate Match |
|-------------|-----------------------|
| RVFLII-1 | < 160 mm / 6.25" |
| RVFLII-2 | 161 mm - 300 mm / 12" |
| RVFLII-3 | 301 mm - 450 mm / 18" |
| RVFLII-4 | 451 mm - 600 mm / 23" |
| RVFLII-5 | 601 mm / 24"+ |

Custom Fixtures

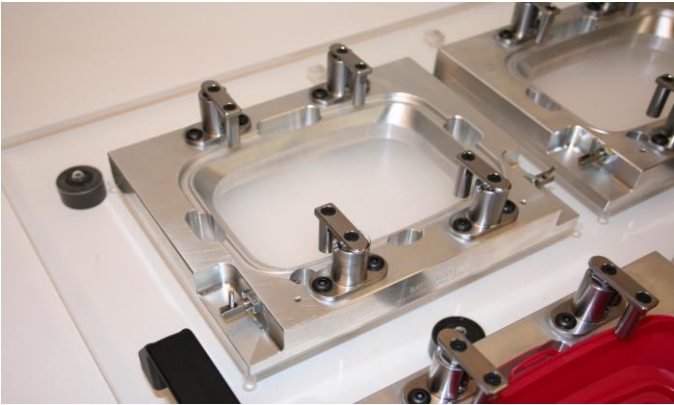

Rayco Fixture also excels in making custom fixtures to fit any part. Whether dedicated or adjustable, we can make a fixture to fit your needs. We have made fixtures for many applications, such as:

- CMM
- Vision System
- Quick Check
- Assembly
- Welding

Get your personalized quote today!



Multiple Setups, ONE Fixture!

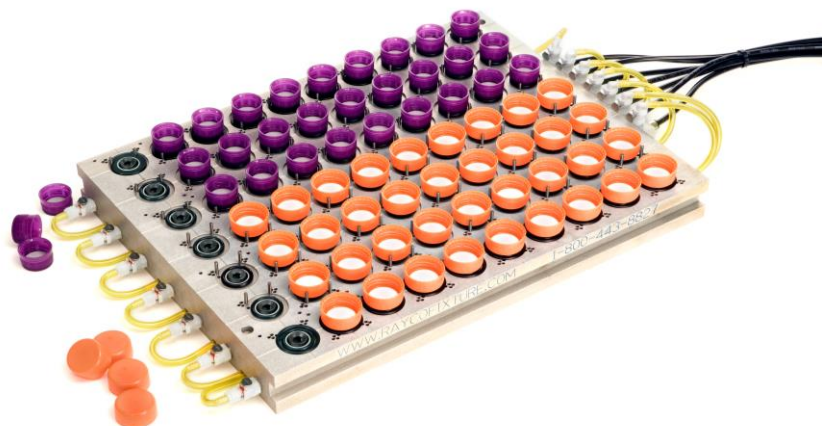

Metrology Tables

"Perfect for your Portable Measurement Device"

Rayco's Metrology Table frames are constructed from extruded aluminum and are matched with a Rayco Fixture Plate of your choice (plate sold separately). Includes Premium "non-grooved" material on the outside surface of frame. Each table is made to order.

Portable Metrology Tables

| Part Number | Length | Width | Height |
|-------------|--------|-------|--------|
| R-2436-MT | 24" | 36" | 36" |
| R-3648-MT | 36" | 48" | 36" |
| R-4260-MT | 42" | 60" | 36" |
| R-4872-MT | 48" | 72" | 36" |
| R-4878-MT | 48" | 78" | 36" |
| R-6096-MT | 60" | 96" | 36" |

Features:

- (2) Heavy Duty Fixed Wheels
- (2) Heavy Duty Swivel Wheels
- (4) Foot Operated Floor Locks
- (1) 1/4" Black ABS Bottom Shelf

Stationary Metrology Tables

| Part Number | Length | Width | Height |
|-------------|--------|-------|--------|
| R-2436-SMT | 24" | 36" | 36" |
| R-3648-SMT | 36" | 48" | 36" |
| R-4872-SMT | 42" | 60" | 36" |
| R-4878-SMT | 48" | 72" | 36" |
| R-4260-SMT | 48" | 78" | 36" |
| R-6096-SMT | 60" | 96" | 36" |

Features:

- (1) 1/4" Black ABS Bottom Shelf
- NO Wheels
- NO Floor Locks



Floor-Locks

Portable Aluminum Table

Clamping Kits: 1/4-20 Thread



R20-CK-C

| Part Numbers | Description | R20-CK-A | R20-CK-B | R20-CK-C |
|-------------------------|-------------------------------------|-----------|------------|------------|
| R20-37550-SO | 3/8" Dia. x 1/2" Standoff | | 3 | 6 |
| R20-5050-SO | 1/2" Dia. X 1/2" Standoff | | | 4 |
| R20-5075-SO | 1/2" Dia. X 3/4" Standoff | 3 | 6 | 8 |
| R20-501-SO | 1/2" Dia. X 1" Standoff | 3 | 6 | 8 |
| R20-502-SO | 1/2" Dia. X 2" Standoff | 3 | 6 | 8 |
| R20-7550-SO | 3/4" Dia. X 1/2" Standoff | | 3 | 4 |
| R20-7575-SO | 3/4" Dia. X 3/4" Standoff | 3 | 6 | 8 |
| R20-751-SO | 3/4" Dia. X 1" Standoff | 3 | 6 | 8 |
| R20-752-SO | 3/4" Dia. X 2" Standoff | 3 | 6 | 8 |
| R20-754-SO | 3/4" Dia. X 4" Standoff | | 4 | 6 |
| R20-175-SO | 1" Dia. X 3/4" Standoff | 3 | 6 | 8 |
| R20-11-SO | 1" Dia. X 1" Standoff | 3 | 6 | 8 |
| R20-12-SO | 1" Dia. X 2" Standoff | 3 | 6 | 8 |
| R20-14-SO | 1" Dia. X 4" Standoff | | 4 | 6 |
| R20-501-PSO: | 1/2" Dia. X 1" Pin Standoff | 2 | 4 | 4 |
| R20-7575-PSO | 3/4" Dia. X 3/4" Pin Standoff | | | 2 |
| R20-ST5-15 | Small Tension Spring - 1.5" Post | 2 | 6 | 6 |
| R20-LTS-3 | Large Tension Spring - 3" Post | 4 | 12 | 12 |
| R20-XLTS | X-Large Tension Spring - 3" Post | | | 3 |
| R20-XLTSP | X-Large Tension Spring with Plunger | | | 3 |
| R20-1-TSB | 1" Dia. Tension Spring Bracket | | | 1 |
| R20-NC | Nylon Cone | 3 | 4 | 6 |
| R20-SRP | Steel Resting Pin | | 4 | 6 |
| R20-APJ | Adjustable Pivot Joint | | | 1 |
| R20-50-JS | 1/2" Dia. Jackstand | 1 | 2 | 3 |
| R20-1-JS | 1" Dia. Jackstand | | 2 | 3 |
| R20-MSLD | Mini Slide Base | 1 | 2 | 3 |
| R20-SLD | Slide Base | 1 | 2 | 4 |
| R20-LB | Locating Block with Base | | 2 | 2 |
| R20-112-MT4 | 1" Sq. x 12" Mini Tower | | | 1 |
| R20-SCT | 1/4-20 Small Component Tray | 1 | | |
| R-CASE-B | Case for B Kit (1 Layer) | | 1 | |
| R-CASE-C | Case for C Kit (2 Layers) | | | 1 |
| Total Components | | 42 | 109 | 159 |

Clamping Kits: M8 Thread



| Part Numbers | Description | R8-CK-A | R8-CK-B | R8-CK-C |
|-------------------------|-------------------------------------|-----------|------------|------------|
| R8-1315-SO | 13mm Dia. X 15mm Standoff | | 3 | 4 |
| R8-1320-SO | 13mm Dia. X 20mm Standoff | 3 | 6 | 8 |
| R8-1325-SO | 13mm Dia. X 25mm Standoff | 3 | 6 | 8 |
| R8-1350-SO | 13mm Dia. X 50mm Standoff | 3 | 6 | 8 |
| R8-1915-SO | 19mm Dia. X 15mm Standoff | | 3 | 4 |
| R8-1920-SO | 19mm Dia. X 20mm Standoff | 3 | 6 | 8 |
| R8-1925-SO | 19 mm Dia. X 25 mm Standoff | 3 | 6 | 8 |
| R8-1950-SO | 19mm Dia. X 50mm Standoff | 3 | 6 | 8 |
| R8-19100-SO | 19mm Dia. X 100mm Standoff | | 4 | 6 |
| R8-2520-SO | 25mm Dia. X 20mm Standoff | 3 | 6 | 8 |
| R8-2525-SO | 25mm Dia. X 25mm Standoff | 3 | 6 | 8 |
| R8-2550-SO | 25mm Dia. X 50mm Standoff | 3 | 6 | 8 |
| R8-25100-SO | 25mm Dia. X 100mm Standoff | | 4 | 6 |
| R8-1325-PSO | 13mm Dia. X 25mm Pin Standoff | 2 | 4 | 6 |
| R8-ST5-38 | Small Tension Spring - 38mm Post | 2 | 6 | 6 |
| R8-LTS-75 | Large Tension Spring - 75mm Post | 4 | 12 | 12 |
| R8-XLTS | X-Large Tension Spring - 75mm Post | | | 3 |
| R8- XLTSP | X-Large Tension Spring with Plunger | | | 3 |
| R8-25-TSB | 25mm Dia. Tension Spring Bracket | | | 1 |
| R8-NC | Nylon Cone | 3 | 4 | 4 |
| R8-SC | Steel Cone | | 4 | 4 |
| R8-PJ | Pivot Joint | | | 1 |
| R8-19-JS | 19mm Dia. Small Jackstand | 1 | 2 | 4 |
| R8-25-JS | 25mm Dia. Large Jackstand | | 2 | 3 |
| R8-SLD | Slide Base | 1 | 3 | 6 |
| R8-LB | Locating Block with Base | | 2 | 2 |
| R8-25300-MT4 | 25mm Sq. X 300mm Mini Tower | | | 1 |
| R8-SCT | M8 Small Component Tray | 1 | | |
| R-CASE-B | Case for B Kit (1 Layer) | | 1 | |
| R-CASE-C | Case for C Kit (2 Layers) | | | 1 |
| Total Components | | 41 | 108 | 149 |

Clamping Kits: M6 Thread



R6-CK-C

| Part Numbers | Description | R6-CK-A | R6-CK-B | R6-CK-C |
|-------------------------|-------------------------------------|-----------|------------|------------|
| R6-910-SO | 9mm Dia. x 10mm Standoff | | 3 | 6 |
| R6-1310-SO | 13mm Dia. x 10mm Standoff | | | 4 |
| R6-1320-SO | 13mm Dia. X 20mm Standoff | 3 | 6 | 8 |
| R6-1325-SO | 13mm Dia. X 25mm Standoff | 3 | 6 | 8 |
| R6-1350-SO: | 13mm Dia. X 50mm Standoff | 3 | 6 | 8 |
| R6-1910-SO | 19mm Dia. X 10mm Standoff | | 3 | 4 |
| R6-1920-SO | 19mm Dia. X 20mm Standoff | 3 | 6 | 8 |
| R6-1925-SO | 19 mm Dia. X 25 mm Standoff | 3 | 6 | 8 |
| R6-1950-SO | 19mm Dia. X 50mm Standoff | 3 | 6 | 8 |
| R6-19100-SO | 19mm Dia. X 100mm Standoff | | 4 | 6 |
| R6-2520-SO | 25mm Dia. X 20mm Standoff | 3 | 6 | 8 |
| R6-2525-SO | 25mm Dia. X 25mm Standoff | 3 | 6 | 8 |
| R6-2550-SO | 25mm Dia. X 50mm Standoff | 3 | 6 | 8 |
| R6-25100-SO | 25mm Dia. X 100mm Standoff | | 4 | 6 |
| R6-1325-PSO | 13mm Dia. X 25mm Pin Standoff | 2 | 4 | 4 |
| R6-1920-PSO | 19mm Dia. X 20mm Pin Standoff | | | 2 |
| R6-ST5-38 | Small Tension Spring - 38mm Post | 2 | 6 | 6 |
| R6-LTS-75 | Large Tension Spring - 75mm Post | 4 | 12 | 12 |
| R6-XLTS | X-Large Tension Spring | | | 3 |
| R6-XLTSP | X-Large Tension Spring with Plunger | | | 3 |
| R6-25-TSB | 25mm Dia. Tension Spring Bracket | | | 1 |
| R6-NC | Nylon Cone | 3 | 4 | 6 |
| R6-SRP | Steel Resting Pin | | 4 | 6 |
| R6-APJ | Adjustable Pivot Joint | | | 1 |
| R6-13-JS | 13mm Dia. Jackstand | 1 | 2 | 3 |
| R6-25-JS | 25mm Dia. Jackstand | | 2 | 3 |
| R6-MSLD | Mini Slide base | 1 | 2 | 3 |
| R6-SLD | Slide Base | 1 | 2 | 4 |
| R6-LB | Locating Block with Base | | 2 | 2 |
| R6-25300-MT4 | 25mm sq. x 300mm Mini Tower | | | 1 |
| R6-SCT | M6 Small Component Tray | 1 | | |
| R-CASE-B | Case for B Kit (1 Layer) | | 1 | |
| R-CASE-C | Case for C Kit (2 Layers) | | | 1 |
| Total Components | | 42 | 109 | 159 |

Clamping Kits: M4 Thread



| Part Numbers | Description | R4-CK-A | R4-CK-B |
|-------------------------|--------------------------------------|-----------|-----------|
| R4-65-SO | 6mm Dia. X 5mm Standoff | | 3 |
| R4-610-SO | 6mm Dia. X 10mm Standoff | 2 | 6 |
| R4-625-SO | 6mm Dia. X 25mm Standoff | 4 | 6 |
| R4-95-SO | 9mm Dia. X 5mm Standoff | 3 | 3 |
| R4-910-SO | 9mm Dia. X 10mm Standoff | 3 | 6 |
| R4-920-SO | 9mm Dia. X 20mm Standoff | | 6 |
| R4-925-SO | 9mm Dia. X 25mm Standoff | 4 | 6 |
| R4-1210-SO | 12mm Dia. X 10mm Standoff | 3 | 6 |
| R4-1225-SO | 12mm Dia. X 25mm Standoff | 4 | 6 |
| R4-610-PSO | 6mm Dia. X 10mm Pin Standoff | 3 | 4 |
| R4-910-PSO | 9mm Dia. X 10mm Pin Standoff | 2 | 4 |
| R4-1210-PSO | 12mm Dia. X 10mm Pin Standoff | | 4 |
| R4-MTS-25 | Mini Tension Spring - 25mm Post | | 4 |
| R4-WTS-32-50 | 32mm Wire Tension Spring - 50mm Post | 3 | 4 |
| R4-WTS-50-50 | 50mm Wire Tension Spring - 50mm Post | 2 | 4 |
| R4-ST5-50 | Small Tension Spring - 50mm Post | 2 | 4 |
| R4-MSLD | Mini Slide Base | 1 | 2 |
| R4-MJS | Mini JackStand | 1 | 2 |
| R4-ARP | Aluminum Resting Pin | 5 | 4 |
| R4-LB | Locating Block with Base | | 1 |
| R4-MCV | Mini Corner Viewer | 1 | 1 |
| R4-PC | Pusher Clamp | | 1 |
| R4-MCT | M4 Mini Component Tray | | 1 |
| AX-BOX | Organizer Box | 1 | |
| Total Components | | 44 | 88 |

Magnetic Clamping Kits: ¼-20 Thread



| Part Numbers | Description | R20-MCK-A | R20-MCK-B | R20-MCK-C |
|-------------------------|----------------------------------|-----------|------------|------------|
| R20-50-M | 1/2" Dia. Magnet | 3 | 4 | 6 |
| R20-75-M | 3/4" Dia. Magnet | 3 | 4 | 6 |
| R20-1-M | 1" Dia. Magnet | 3 | 4 | 6 |
| R20-50-PM | 1/2" Dia. Pin Magnet | | 2 | 2 |
| R20-75-PM | 3/4" Dia. Pin Magnet | | | 2 |
| R20-37550-SO | 3/8" Dia. x 1/2" Standoff | | 3 | 4 |
| R20-5050-SO | 1/2" Dia. X 1/2" Standoff | | | 4 |
| R20-5075-SO | 1/2" Dia. X 3/4" Standoff | 3 | 6 | 8 |
| R20-501-SO | 1/2" Dia. X 1" Standoff | 3 | 6 | 8 |
| R20-502-SO | 1/2" Dia. X 2" Standoff | 3 | 6 | 8 |
| R20-7550-SO | 3/4" Dia. X 1/2" Standoff | | 3 | 4 |
| R20-7575-SO | 3/4" Dia. X 3/4" Standoff | 3 | 6 | 8 |
| R20-751-SO | 3/4" Dia. X 1" Standoff | 3 | 6 | 8 |
| R20-752-SO | 3/4" Dia. X 2" Standoff | 3 | 6 | 8 |
| R20-754-SO | 3/4" Dia. X 4" Standoff | | 3 | 6 |
| R20-175-SO | 1" Dia. X 3/4" Standoff | 3 | 6 | 8 |
| R20-11-SO | 1" Dia. X 1" Standoff | 3 | 6 | 8 |
| R20-12-SO | 1" Dia. X 2" Standoff | 3 | 6 | 8 |
| R20-14-SO | 1" Dia. X 4" Standoff | | 3 | 6 |
| R20-ST3-3 | Small Tension Spring - 3" Post | 4 | | |
| R20-ST3-15 | Small Tension Spring - 15" Post | | 4 | 4 |
| R20-LT3-3 | Large Tension Spring - 3" Post | | 8 | 8 |
| R20-XLT3 | X-Large Tension Spring - 3" Post | | | 2 |
| R20-1-TSB | 1" Dia. Tension Spring Bracket | | | 1 |
| R20-NC | Nylon Cone | 3 | 4 | 6 |
| R20-SRP | Steel Resting Pin | | 4 | 6 |
| R20-APJ | Adjustable Pivot Joint | | | 1 |
| R20-50-JS | 1/2" Dia. Jackstand | 1 | 2 | 3 |
| R20-1-JS | 1" Dia. Jackstand | | 2 | 3 |
| R20-MSLD | Mini Slide Base | 1 | 2 | 3 |
| R20-SLD | Slide Base | 1 | 2 | 3 |
| R20-LB | Locating Block with Base | | 2 | 2 |
| R20-112-MT4 | 1" Sq. x 12" Mini Tower | | | 1 |
| R20-SCT | 1/4-20 Small Component Tray | 1 | 1 | 2 |
| Total Components | | 47 | 111 | 163 |

Magnetic Clamping Kits: M8 Thread



| Part Numbers | Description | R8-MCK-A | R8-MCK-B | R8-MCK-C |
|-------------------------|------------------------------------|----------|----------|----------|
| R8-13-M | 13mm Dia. Magnet | 3 | 4 | 6 |
| R8-19-M | 19mm Dia. Magnet | 3 | 4 | 6 |
| R8-25-M | 25mm Dia. Magnet | 3 | 4 | 6 |
| R8-13-PM | 13mm Dia. Pin Magnet | | 2 | 2 |
| R8-19-PM | 19mm Dia. Pin Magnet | | | 2 |
| R8-1315-SO | 13mm Dia. X 15mm Standoff | | 3 | 3 |
| R8-1320-SO | 13mm Dia. X 20mm Standoff | 3 | 6 | 8 |
| R8-1325-SO | 13mm Dia. X 25mm Standoff | 3 | 6 | 8 |
| R8-1350-SO | 13mm Dia. X 50mm Standoff | 3 | 6 | 8 |
| R8-1915-SO | 19mm Dia. X 15mm Standoff | | 3 | 3 |
| R8-1920-SO | 19mm Dia. X 20mm Standoff | 3 | 6 | 8 |
| R8-1925-SO | 19mm Dia. X 25mm Standoff | 3 | 6 | 8 |
| R8-1950-SO | 19mm Dia. X 50mm Standoff | 3 | 6 | 8 |
| R8-19100-SO | 19mm Dia. X 100mm Standoff | | 4 | 6 |
| R8-2520-SO | 25mm Dia. X 20mm Standoff | 3 | 6 | 8 |
| R8-2525-SO | 25mm Dia. X 25mm Standoff | 3 | 6 | 8 |
| R8-2550-SO | 25mm Dia. X 50mm Standoff | 3 | 6 | 8 |
| R8-25100-SO | 25mm Dia. X 100mm Standoff | | 4 | 6 |
| R8-STS-38 | Small Tension Spring - 38mm Post | | 4 | 4 |
| R8-LTS-75 | Large Tension Spring - 75mm Post | 3 | 8 | 8 |
| R8-XLTS | X-Large Tension Spring - 75mm Post | | | 2 |
| R8-25-TSB | 25mm Dia. Tension Spring Bracket | | | 1 |
| R8-NC | Nylon Cone | 3 | 4 | 4 |
| R8-SC | Steel Cone | | 4 | 4 |
| R8-PJ | Pivot Joint | | | 1 |
| R8-19-JS | 19mm Dia. Small Jackstand | 1 | 2 | 3 |
| R8-25-JS | 25mm Dia. Large Jackstand | | 2 | 3 |
| R8-SLD | Slide Base | 1 | 3 | 5 |
| R8-LB | Locating Block with Base | | 2 | 2 |
| R8-25300-MT4 | 25mm Sq. X 300mm Mini Tower | | | 1 |
| R8-SCT | M8 Small Component Tray | 1 | 1 | 2 |
| Total Components | | 45 | 112 | 152 |

Magnetic Clamping Kits: M6 Thread



| Part Numbers | Description | R6-MCK-A | R6-MCK-B | R6-MCK-C |
|-------------------------|------------------------------------|----------|----------|----------|
| R6-13-M | 13mm Dia. Magnet | 3 | 4 | 6 |
| R6-19-M | 19mm Dia. Magnet | 3 | 4 | 6 |
| R6-25-M | 25mm Dia. Magnet | 3 | 4 | 6 |
| R6-13-PM | 13mm Dia. Pin Magnet | | 2 | 2 |
| R6-19-PM | 19mm Dia. Pin Magnet | | | 2 |
| R6-910-SO | 9mm Dia. X 10mm Standoff | | 3 | 4 |
| R6-1310-SO | 13mm Dia. X 10mm Standoff | | | 4 |
| R6-1320-SO | 13mm Dia. X 20mm Standoff | 3 | 6 | 8 |
| R6-1325-SO | 13mm Dia. X 25mm Standoff | 3 | 6 | 8 |
| R6-1350-SO | 13mm Dia. X 50mm Standoff | 3 | 6 | 8 |
| R6-1910-SO | 19mm Dia. X 10mm Standoff | | 3 | 4 |
| R6-1920-SO | 19mm Dia. X 20mm Standoff | 3 | 6 | 8 |
| R6-1925-SO | 19mm Dia. X 25mm Standoff | 3 | 6 | 8 |
| R6-1950-SO | 19mm Dia. X 50mm Standoff | 3 | 6 | 8 |
| R6-19100-SO | 19mm Dia. X 100mm Standoff | | 3 | 6 |
| R6-2520-SO | 25mm Dia. X 20mm Standoff | 3 | 6 | 8 |
| R6-2525-SO | 25mm Dia. X 25mm Standoff | 3 | 6 | 8 |
| R6-2550-SO | 25mm Dia. X 50mm Standoff | 3 | 6 | 8 |
| R6-25100-SO | 25mm Dia. X 100mm Standoff | | 3 | 6 |
| R6-ST38 | Small Tension Spring - 38mm Post | | 4 | 4 |
| R6-LTS-75 | Large Tension Spring - 75mm Post | 3 | 8 | 8 |
| R6-XLTS | X-Large Tension Spring - 75mm Post | | | 2 |
| R6-25-TSB | 25mm Dia. Tension Spring Bracket | | | 1 |
| R6-NC | Nylon Cone | 3 | 4 | 6 |
| R6-SRP | Steel Resting Pin | | 4 | 6 |
| R6-APJ | Adjustable Pivot Joint | | | 1 |
| R6-13-JS | 13mm Dia. Small Jackstand | 1 | 2 | 3 |
| R6-25-JS | 25mm Dia. Large Jackstand | | 2 | 3 |
| R6-MSLD | Mini Slide Base | | 2 | 3 |
| R6-SLD | Slide Base | 1 | 2 | 3 |
| R6-LB | Locating Block with Base | | 2 | 2 |
| R6-25300-MT4 | 25mm sq. x 300mm Mini Tower | | | 1 |
| R6-SCT | M6 Small Component Tray | 1 | 1 | 2 |
| Total Components | | 45 | 111 | 163 |

Magnetic Clamping Kits: M4 Thread



| Part Numbers | Description | R4-MCK-A |
|-------------------------|--------------------------------------|-----------|
| R4-6-M | 6mm Dia. Magnet | 3 |
| R4-13-M | 13mm Dia. Magnet | 3 |
| R4-6-PM | 6mm Dia. Pin Magnet | 3 |
| R4-65-SO | 6mm Dia. X 5mm Standoff | 3 |
| R4-610-SO | 6mm Dia. X 10mm Standoff | 3 |
| R4-625-SO | 6mm Dia. X 25mm Standoff | 3 |
| R4-95-SO | 9mm Dia. X 5mm Standoff | 3 |
| R4-910-SO | 9mm Dia. X 10mm Standoff | 3 |
| R4-925-SO | 9mm Dia. X 25mm Standoff | 3 |
| R4-625-PSO | 6mm Dia. X 25mm Pin Standoff | 3 |
| R4-MTS-25 | Mini Tension Spring - 25mm Post | 2 |
| R4-MTS-50 | Mini Tension Spring - 50mm Post | 2 |
| R4-WTS-32-25 | 32mm Wire Tension Spring - 25mm Post | 2 |
| R4-WTS-50-50 | 50mm Wire Tension Spring - 50mm Post | 2 |
| R4-ST5-25 | Small Tension Spring - 25mm Post | 2 |
| R4-MSLD | Mini Slide Base | 1 |
| R4-ARP | Aluminum Resting Pin | 4 |
| R4-CV | Corner Viewer | 1 |
| R4-MCV | Mini Corner Viewer | 1 |
| R4-PC | Pusher Clamp | 1 |
| AX-BOX | Organizer Box | 1 |
| Total Components | | 49 |

Vacuum Clamping Kits: ¼-20 Thread



| Part Numbers | Description | R20-VCK-A | R20-VCK-B |
|-------------------------|----------------------------------|-----------|-----------|
| R20-10-SC | 10mm Suction Cup | 3 | 3 |
| R20-20-SC | 20mm Suction Cup | 4 | 4 |
| R20-30-SC | 30mm Suction Cup | | 2 |
| R20-50-SC | 50mm Suction Cup | 1 | 1 |
| R20-20-EXSC | 20mm Exposed Suction Cup | 2 | 2 |
| R-9P-M | 9-Port Manifold | 1 | 1 |
| R-X10L-VP | Vacuum Pump Assembly | 1 | 1 |
| R-12-VH | Vacuum Hose 12" Long | 20 | 20 |
| R-PMCD2202 | Straight Hose Barb Connector | 1 | 1 |
| R-PMC23028 | Elbow Connector | 8 | 8 |
| R20-37550-SO | 3/8" Dia. x 1/2" Standoff | 3 | 3 |
| R20-5075-SO | 1/2" Dia. X 3/4" Standoff | | 6 |
| R20-501-SO | 1/2" Dia. X 1" Standoff | 4 | 6 |
| R20-502-SO | 1/2" Dia. X 2" Standoff | | 6 |
| R20-7550-SO | 3/4" Dia. X 1/2" Standoff | 3 | 3 |
| R20-7575-SO | 3/4" Dia. X 3/4" Standoff | | 6 |
| R20-751-SO | 3/4" Dia. X 1" Standoff | 4 | 6 |
| R20-752-SO | 3/4" Dia. X 2" Standoff | 4 | 6 |
| R20-753-SO | 3/4" Dia. X 3" Standoff | | 3 |
| R20-175-SO | 1" Dia. X 3/4" Standoff | 6 | 6 |
| R20-11-SO | 1" Dia. X 1" Standoff | 4 | 6 |
| R20-12-SO | 1" Dia. X 2" Standoff | 4 | 6 |
| R20-14-SO | 1" Dia. X 4" Standoff | 3 | 3 |
| R20-ST5-15 | Small Tension Spring - 1.5" Post | 4 | 4 |
| R20-LTS-3 | Large Tension Spring - 3" Post | 4 | 8 |
| R20-NC | Nylon Cone | 4 | 4 |
| R20-SRP | Steel Resting Pin | 4 | 4 |
| R20-50-JS | 1/2" Dia. Jackstand | | 2 |
| R20-1-JS | 1" Dia. Jackstand | 2 | 2 |
| R20-MSLD | Mini Slide Base | 2 | 2 |
| R20-SLD | Slide Base | 2 | 2 |
| R20-LB | Locating Block with Base | 2 | 2 |
| R20-SCT | 1/4-20 Small Component Tray | 1 | 1 |
| R-VCT | Vacuum Component Tray | 1 | 1 |
| Total Components | | 102 | 141 |

Vacuum Clamping Kits: M8 Thread



| Part Numbers | Description | R8-VCK-A | R8-VCK-B |
|-------------------------|---------------------------------|----------|----------|
| R8-10-SC | 10mm Suction Cup | 3 | 3 |
| R8-20-SC | 20mm Suction Cup | 4 | 4 |
| R8-30-SC | 30mm Suction Cup | 2 | 2 |
| R8-50-SC | 50mm Suction Cup | 1 | 1 |
| R8-20-EXSC | 20mm Exposed Suction Cup | 2 | 2 |
| R-9P-M | 9-Port Manifold | 1 | 1 |
| R-X10L-VP | Vacuum Pump Assembly | 1 | 1 |
| R-12-VH | Vacuum Hose 12" Long | 20 | 20 |
| R-PMCD2202 | Straight Hose Barb Connector | 1 | 1 |
| R-PMC23028 | Elbow Connector | 8 | 11 |
| R8-1320-SO | 13mm Dia. X 20mm Standoff | | 6 |
| R8-1325-SO | 13mm Dia. X 25mm Standoff | 6 | 6 |
| R8-1350-SO | 13mm Dia. X 50 mm Standoff | 6 | 6 |
| R8-1915-SO | 19mm Dia. X 15mm Standoff | 3 | 3 |
| R8-1920-SO | 19mm Dia. X 20mm Standoff | | 6 |
| R8-1925-SO | 19mm Dia. X 25mm Standoff | 6 | 6 |
| R20-1950-SO | 19mm Dia. X 50mm Standoff | | 6 |
| R8-1975-SO | 19mm Dia. X 75mm Standoff | 3 | 2 |
| R8-2520-SO | 25mm Dia. X 20mm Standoff | | 6 |
| R8-2525-SO | 25mm Dia. X 25mm Standoff | 6 | 6 |
| R8-2550-SO | 25mm Dia. X 50mm Standoff | | 6 |
| R8-25100-SO | 25mm Dia. X 100mm Standoff | | 3 |
| R8-STS-38 | Small Tension Spring -38mm Post | 4 | 4 |
| R8-LTS-75 | Large Tension Spring -75mm Post | 8 | 8 |
| R8-NC | Nylon Cone | 4 | 4 |
| R8-SC | Steel Cone | 4 | 4 |
| R8-19-JS | 19mm Dia. Small Jackstand | 2 | 2 |
| R8-25-JS | 25mm Dia. Large Jackstand | | 2 |
| R8-SLD | Slide Base | | 3 |
| R8-LB | Locating Block with Base | | 2 |
| R8-SCT | M8 Small Component Tray | 1 | 1 |
| R-VCT | Vacuum Component Tray | 1 | 1 |
| Total Components | | 97 | 139 |

Vacuum Clamping Kits: M6 Thread



| Part Numbers | Description | R6-VCK-A | R6-VCK-B |
|-------------------------|----------------------------------|------------|------------|
| R6-10-SC | 10mm Suction Cup | 3 | 3 |
| R6-20-SC | 20mm Suction Cup | 4 | 4 |
| R6-30-SC | 30mm Suction Cup | | 2 |
| R6-50-SC | 50mm Suction Cup | 1 | 1 |
| R6-20-EXSC | 20mm Exposed Suction Cup | 2 | 2 |
| R-9P-M | 9-Port Manifold | 1 | 1 |
| R-X10L-VP | Vacuum Pump Assembly | 1 | 1 |
| R-12-VH | Vacuum Hose 12" Long | 20 | 20 |
| R-PMCD2202 | Straight Hose Barb Connector | 8 | 8 |
| R-PMC23028 | Elbow Connector | 1 | 1 |
| R6-910-SO | 9mm Dia. X 10mm Standoff | 3 | 3 |
| R6-1320-SO | 13mm Dia. X 20mm Standoff | | 6 |
| R6-1325-SO | 13mm Dia. X 25mm Standoff | 4 | 6 |
| R6-1350-SO | 13mm Dia. X 50mm Standoff | | 6 |
| R6-1910-SO | 19mm Dia. X 10mm Standoff | 3 | 3 |
| R6-1920-SO | 19mm Dia. X 20mm Standoff | | 6 |
| R6-1925-SO | 19mm Dia. X 25mm Standoff | 4 | 6 |
| R6-1950-SO | 19mm Dia. X 50mm Standoff | 4 | 6 |
| R6-19100-SO | 19mm Dia. X 100mm Standoff | | 3 |
| R6-2520-SO | 25mm Dia. X 20mm Standoff | 6 | 6 |
| R6-2525-SO | 25mm Dia. X 25mm Standoff | 4 | 6 |
| R6-2550-SO | 25mm Dia. X 50mm Standoff | 4 | 6 |
| R6-25100-SO | 25mm Dia. X 100mm Standoff | 3 | 3 |
| R6-STS-38 | Small Tension Spring - 38mm Post | 4 | 4 |
| R6-LTS-75 | Large Tension Spring - 75mm Post | 4 | 8 |
| R6-NC | Nylon Cone | 4 | 4 |
| R6-SRP | Steel Resting Pin | 4 | 4 |
| R6-13-JS | 13mm Dia. Small Jackstand | | 2 |
| R6-25-JS | 25mm Dia. Large Jackstand | 2 | 2 |
| R6-MSLD | Mini Slide Base | 2 | 2 |
| R6-SLD | Slide Base | 2 | 2 |
| R6-LB | Locating Block with Base | 2 | 2 |
| R6-SCT | M6 Small Component Tray | 1 | 1 |
| R-VCT | Vacuum Component Tray | 1 | 1 |
| Total Components | | 102 | 141 |

Vision Clamping Kits: 1/4-20 Thread



RA20-VK-A

| Part Numbers | Description | RA20-VK-A | RA20-VK-B | RA20-VK-C |
|-------------------------|-------------------------------------|-----------|-----------|------------|
| R20-2550-SO | 1/4" Dia. X 1/2" Standoff | 3 | 6 | 8 |
| R20-251-SO | 1/4" Dia. X 1" Standoff | 3 | 6 | 8 |
| R20-37525-SO | 3/8" Dia. X 1/4" Standoff | 3 | 3 | 8 |
| R20-37550-SO | 3/8" Dia. X 1/2" Standoff | 3 | 6 | 8 |
| R20-37575-SO | 3/8" Dia. X 3/4" Standoff | | 6 | 8 |
| R20-3751-SO | 3/8" Dia. X 1" Standoff | 3 | 6 | 6 |
| R20-5050-SO | 1/2" Dia. X 1/2" Standoff | 3 | 6 | 6 |
| R20-501-SO | 1/2" Dia. X 1" Standoff | | 6 | 6 |
| R20-2550-PSO | 1/4" Dia. X 1/2" Pin Standoff | 2 | 4 | 6 |
| R20-37550-PSO | 3/8" Dia. X 1/2" Pin Standoff | 2 | 4 | 6 |
| R20-501-PSO | 1/2" Dia. X 1" Pin Standoff | | 4 | 4 |
| R20-MTS-1 | Mini Tension Spring - 1" Post | 2 | 3 | 6 |
| R20-MTS-2 | Mini Tension Spring - 2" Post | | 3 | 6 |
| R20-ST5-15 | Small Tension Spring - 1.5" Post | | 6 | 6 |
| R20-WTS-125-1 | 1.25" Wire Tension Spring - 1" Post | 3 | 3 | 4 |
| R20-WTS-2-2 | 2" Wire Tension Spring - 2" Post | 3 | 3 | 4 |
| R20-SRP | Steel Resting Pin | 4 | 4 | 4 |
| R20-CV | Corner Viewer | | 1 | 1 |
| R20-MCV | Mini Corner Viewer | 1 | | |
| R20-50-JS | 1/2" Dia. Small Jackstand | 1 | 2 | 2 |
| R20-MSLD | Mini Slide Base | 1 | 2 | 2 |
| R20-PC | Pusher Clamp | | 1 | 1 |
| R20-LB | Locating Block with Base | 1 | | |
| R20-SCT | 1/4-20 Small Component Tray | | 1 | 1 |
| AX-BOX | Organizer Box | 1 | | |
| Total Components | | 39 | 86 | 111 |

Vision Clamping Kits: M6 Thread



RA6-VK-C

| Part Numbers | Description | RA6-VK-A | RA6-VK-B | RA6-VK-C |
|-------------------------|--------------------------------------|-----------|-----------|------------|
| R6-610-SO | 6mm Dia. X 10mm Standoff | 3 | 6 | 8 |
| R6-625-SO | 6mm Dia. X 25mm Standoff | 3 | 6 | 8 |
| R6-95-SO | 9mm Dia. X 5mm Standoff | 3 | 3 | 8 |
| R6-910-SO | 9mm Dia. X 10mm Standoff | 3 | 6 | 8 |
| R6-920-SO | 9mm Dia. X 20mm Standoff | | 6 | 8 |
| R6-925-SO | 9mm Dia. X 25mm Standoff | 3 | 6 | 6 |
| R6-1310-SO | 13mm Dia. X 10mm Standoff | 3 | 6 | 6 |
| R6-1325-SO | 13mm Dia. X 25mm Standoff | | 6 | 6 |
| R6-610-PSO | 6mm Dia. X 10mm Pin Standoff | 2 | 4 | 6 |
| R6-910-PSO | 9mm Dia. X 10mm Pin Standoff | 2 | 4 | 6 |
| R6-1325-PSO | 13mm Dia. X 25mm Pin Standoff | | 4 | 4 |
| R6-MTS-25 | Mini Tension Spring - 25mm Post | 2 | 3 | 6 |
| R6-MTS-50: | Mini Tension Spring - 50mm Post | | 3 | 6 |
| R6-STS-38 | Small Tension Spring - 38mm Post | | 6 | 6 |
| R6-WTS-32-25 | 32mm Wire Tension Spring - 25mm Post | 3 | 3 | 4 |
| R6-WTS-50-50 | 50mm Wire Tension Spring - 50mm Post | 3 | 3 | 4 |
| R6-SRP | Steel Resting Pin | 4 | 4 | 4 |
| R6-CV | Corner Viewer | 1 | 1 | 1 |
| R6-13-JS | 13mm Dia. Jackstand | 1 | 2 | 2 |
| R6-MSLD | Mini Slide Base | 1 | 2 | 2 |
| R6-LB | Locating Block with Base | 1 | | |
| R6-PC | Pusher Clamp | | 1 | 1 |
| R6-SCT | M6 Small Component Tray | | 1 | 1 |
| AX-BOX | Organizer Box | 1 | | |
| Total Components | | 39 | 86 | 111 |

Vision Clamping Kits: M4 Thread



| Part Numbers | Description | RA4-VK-A | RA4-VK-B | RA4-VK-C |
|-------------------------|--------------------------------------|-----------|-----------|------------|
| R4-65-SO | 6mm Dia. X 5mm Standoff | | 3 | 6 |
| R4-610-SO | 6mm Dia. X 10mm Standoff | 3 | 6 | 8 |
| R4-625-SO | 6mm Dia. X 25mm Standoff | 3 | 6 | 8 |
| R4-95-SO | 9mm Dia. X 5mm Standoff | 3 | 3 | 4 |
| R4-910-SO | 9mm Dia. X 10mm Standoff | 3 | 6 | 8 |
| R4-920-SO | 9mm Dia. X 20mm Standoff | | 6 | 8 |
| R4-925-SO | 9mm Dia. X 25mm Standoff | 3 | 6 | 8 |
| R4-1210-SO | 12mm Dia. X 10mm Standoff | 3 | 6 | 8 |
| R4-1225-SO | 12mm Dia. X 25mm Standoff | | 6 | 8 |
| R4-610-PSO | 6mm Dia. X 10mm Pin Standoff | 2 | 4 | 6 |
| R4-910-PSO | 9mm Dia. X 10mm Pin Standoff | 2 | 4 | 6 |
| R4-1210-PSO | 12mm Dia. X 10mm Pin Standoff | | 4 | 6 |
| R4-MTS-25 | Mini Tension Spring - 25mm Post | 3 | 4 | 8 |
| R4-WTS-32-25 | 32mm Wire Tension Spring - 25mm Post | 3 | 4 | 8 |
| R4-WTS-50-50 | 50mm Wire Tension Spring - 50mm Post | 2 | 4 | 8 |
| R4-ST5-50 | Small Tension Spring - 50mm Post | 2 | 4 | 8 |
| R4-MSLD | Mini Slide Base | 1 | 2 | 2 |
| R4-MJS | Mini JackStand | 2 | 2 | 2 |
| R4-ARP | Aluminum Resting Pin | 4 | 4 | 6 |
| R4-LB | Locating Block with Base | | 1 | 1 |
| R4-MCV | Mini Corner Viewer | 1 | 1 | 1 |
| R4-PC | Pusher Clamp | | 1 | 2 |
| R4-MCT | M4 Mini Component Tray | | 1 | 1 |
| AX-BOX | Organizer Box | 1 | | |
| Total Components | | 41 | 88 | 131 |

Small Tension Spring

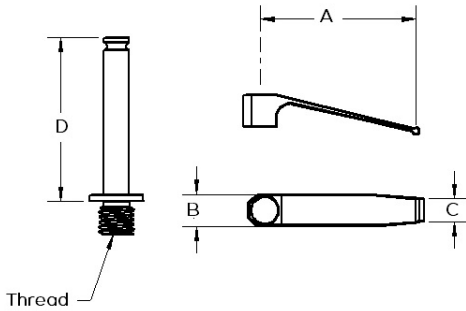

| Part Number | Thread | A | B | C | D |
|-------------------------------|--------|-------|---------|---------|-------|
| R20-ST5-15 | 1/4-20 | 15" | 0.3" | 0.125" | 15" |
| R20-ST5-3 | 1/4-20 | 15" | 0.3" | 0.125" | 3" |
| R20-ST5-15-RT (Rubber Tipped) | 1/4-20 | 15" | 0.3" | 0.125" | 15" |
| R20-ST5-3-RT (Rubber Tipped) | 1/4-20 | 15" | 0.3" | 0.125" | 3" |
| R8-ST5-38 | M8 | 38 mm | 7.62 mm | 3.29 mm | 38 mm |
| R8-ST5-75 | M8 | 38 mm | 7.62 mm | 3.29 mm | 75 mm |
| R8-ST5-38-RT (Rubber Tipped) | M8 | 38 mm | 7.62 mm | 3.29 mm | 38 mm |
| R8-ST5-75-RT (Rubber Tipped) | M8 | 38 mm | 7.62 mm | 3.29 mm | 75 mm |
| R6-ST5-38 | M6 | 38 mm | 7.62 mm | 3.29 mm | 38 mm |
| R6-ST5-75 | M6 | 38 mm | 7.62 mm | 3.29 mm | 75 mm |
| R6-ST5-38-RT (Rubber Tipped) | M6 | 38 mm | 7.62 mm | 3.29 mm | 38 mm |
| R6-ST5-75-RT (Rubber Tipped) | M6 | 38 mm | 7.62 mm | 3.29 mm | 75 mm |
| R4-ST5-25 | M4 | 38 mm | 7.62 mm | 3.29 mm | 25 mm |
| R4-ST5-50 | M4 | 38 mm | 7.62 mm | 3.29 mm | 50 mm |
| R4-ST5-25-RT (Rubber Tipped) | M4 | 38 mm | 7.62 mm | 3.29 mm | 25 mm |
| R4-ST5-50-RT (Rubber Tipped) | M4 | 38 mm | 7.62 mm | 3.29 mm | 50 mm |

Large Tension Spring

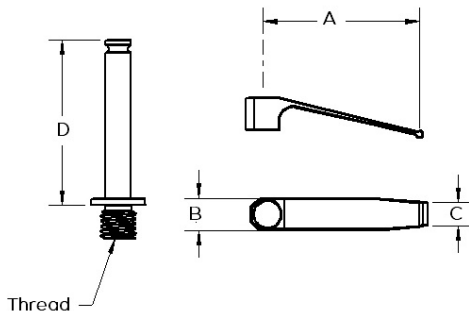

| Part Number | Thread | A | B | C | D |
|-------------------------------|--------|-------|---------|--------|-------|
| R20-LTS-15 | 1/4-20 | 2.30" | 0.5" | 0.3" | 15" |
| R20-LTS-3 | 1/4-20 | 2.30" | 0.5" | 0.3" | 3" |
| R20-LTS-15-RT (Rubber Tipped) | 1/4-20 | 2.30" | 0.5" | 0.3" | 15" |
| R20-LTS-3-RT (Rubber Tipped) | 1/4-20 | 2.30" | 0.5" | 0.3" | 3" |
| R8-LTS-38 | M8 | 58 mm | 12.7 mm | 6.5 mm | 38 mm |
| R8-LTS-75 | M8 | 58 mm | 12.7 mm | 6.5 mm | 75 mm |
| R8-LTS-38-RT (Rubber Tipped) | M8 | 58 mm | 12.7 mm | 6.5 mm | 38 mm |
| R8-LTS-75-RT (Rubber Tipped) | M8 | 58 mm | 12.7 mm | 6.5 mm | 75 mm |
| R6-LTS-38 | M6 | 58 mm | 12.7 mm | 6.5 mm | 38 mm |
| R6-LTS-75 | M6 | 58 mm | 12.7 mm | 6.5 mm | 75 mm |
| R6-LTS-38-RT (Rubber Tipped) | M6 | 58 mm | 12.7 mm | 6.5 mm | 38 mm |
| R6-LTS-75-RT (Rubber Tipped) | M6 | 58 mm | 12.7 mm | 6.5 mm | 75 mm |
| R4-LTS-25 | M4 | 58 mm | 12.7 mm | 6.5 mm | 25 mm |
| R4-LTS-50 | M4 | 58 mm | 12.7 mm | 6.5 mm | 50 mm |
| R4-LTS-25-RT (Rubber Tipped) | M4 | 58 mm | 12.7 mm | 6.5 mm | 25 mm |
| R4-LTS-50-RT (Rubber Tipped) | M4 | 58 mm | 12.7 mm | 6.5 mm | 50 mm |

| Part Number | Thread | A | B | C | D |
|-----------------------------|--------|-------|-------|--------|-------|
| R20-XLTS | 1/4-20 | 3.42" | 0.75" | 0.375" | 3" |
| R20-XLTS-RT (Rubber Tipped) | 1/4-20 | 3.42" | 0.75" | 0.375" | 3" |
| R8-XLTS | M8 | 87 mm | 19 mm | 9.5 mm | 76 mm |
| R20-XLTS-RT (Rubber Tipped) | M8 | 87 mm | 19 mm | 9.5 mm | 76 mm |
| R6-XLTS | M6 | 87 mm | 19 mm | 9.5 mm | 76 mm |
| R6-XLTS-RT (Rubber Tipped) | M6 | 87 mm | 19 mm | 9.5 mm | 76 mm |

X-Large Tension Spring

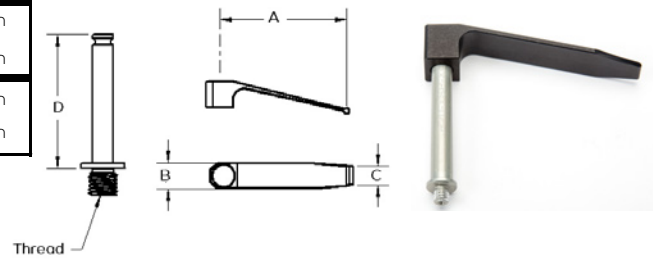

| Part Number | Thread | A | B | C | D |
|-------------|--------|--------|-------|--------|-------|
| R20-XLTSP | 1/4-20 | 3.625" | 0.75" | 0.275" | 3" |
| R8-XLTSP | M8 | 92 mm | 19 mm | 7 mm | 76 mm |
| R6-XLTSP | M6 | 92 mm | 19 mm | 7 mm | 76 mm |

X-Large Tension Spring with Plunger

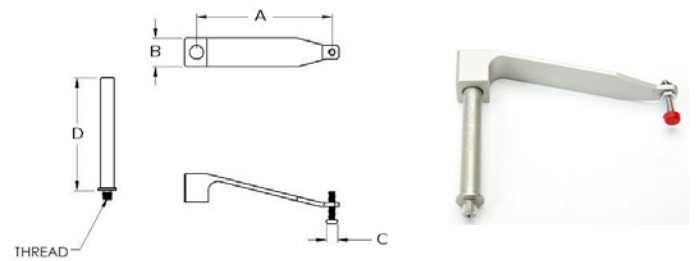

| Part Number | Thread | A | B |
|----------------------------------|--------|-------|-------|
| R20-WTS-125-1 | 1/4-20 | 1.25" | 1" |
| R20-WTS-2-2 | 1/4-20 | 2" | 2" |
| R20-WTS-125-2 | 1/4-20 | 1.25" | 2" |
| R20-WTS-2-1 | 1/4-20 | 2" | 1" |
| R20-WTS-125-1-RT (Rubber Tipped) | 1/4-20 | 1.25" | 1" |
| R20-WTS-2-2-RT (Rubber Tipped) | 1/4-20 | 2" | 2" |
| R20-WTS-125-2-RT (Rubber Tipped) | 1/4-20 | 1.25" | 2" |
| R20-WTS-2-1-RT (Rubber Tipped) | 1/4-20 | 2" | 1" |
| R6-WTS-32-25 | M6 | 32 mm | 25 mm |
| R6-WTS-50-50 | M6 | 50 mm | 50 mm |
| R6-WTS-32-50 | M6 | 32 mm | 50 mm |
| R6-WTS-50-25 | M6 | 50 mm | 25 mm |
| R6-WTS-32-25-RT (Rubber Tipped) | M6 | 32 mm | 25 mm |
| R6-WTS-50-50-RT (Rubber Tipped) | M6 | 50 mm | 50 mm |
| R6-WTS-32-50-RT (Rubber Tipped) | M6 | 32 mm | 50 mm |
| R6-WTS-50-25-RT (Rubber Tipped) | M6 | 50 mm | 25 mm |
| R4-WTS-32-25 | M4 | 32 mm | 25 mm |
| R4-WTS-50-50 | M4 | 50 mm | 50 mm |
| R4-WTS-50-25 | M4 | 50 mm | 25 mm |
| R4-WTS-32-50 | M4 | 32 mm | 50 mm |
| R4-WTS-32-25-RT (Rubber Tipped) | M4 | 32 mm | 25 mm |
| R4-WTS-50-50-RT (Rubber Tipped) | M4 | 50 mm | 50 mm |
| R4-WTS-50-25-RT (Rubber Tipped) | M4 | 50 mm | 25 mm |
| R4-WTS-32-50-RT (Rubber Tipped) | M4 | 32 mm | 50 mm |

Wire Tension Springs

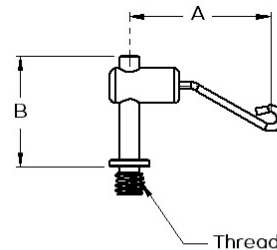

Mini Tension Springs

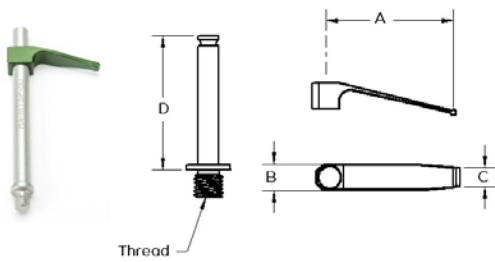

| Part Number | Thread | A | B | C | D |
|------------------------------|--------|-------|--------|-------|-------|
| R20-MTS-1 | 1/4-20 | 0.84" | 0.25" | 0.08" | 1" |
| R20-MTS-2 | 1/4-20 | 0.84" | 0.25" | 0.08" | 2" |
| R20-MTS-1-RT (Rubber Tipped) | 1/4-20 | 0.84" | 0.25" | 0.08" | 1" |
| R20-MTS-2-RT (Rubber Tipped) | 1/4-20 | 0.84" | 0.25" | 0.08" | 2" |
| R6-MTS-25 | M6 | 21 mm | 6.3 mm | 2 mm | 25 mm |
| R6-MTS-50 | M6 | 21 mm | 6.3 mm | 2 mm | 50 mm |
| R6-MTS-25-RT (Rubber Tipped) | M6 | 21 mm | 6.3 mm | 2 mm | 25 mm |
| R6-MTS-50-RT (Rubber Tipped) | M6 | 21 mm | 6.3 mm | 2 mm | 50 mm |
| R4-MTS-25 | M4 | 21 mm | 6.3 mm | 2 mm | 25 mm |
| R4-MTS-50 | M4 | 21 mm | 6.3 mm | 2 mm | 50 mm |
| R4-MTS-25-RT (Rubber Tipped) | M4 | 21 mm | 6.3 mm | 2 mm | 25 mm |
| R4-MTS-50-RT (Rubber Tipped) | M4 | 21 mm | 6.3 mm | 2 mm | 50 mm |

Standoffs

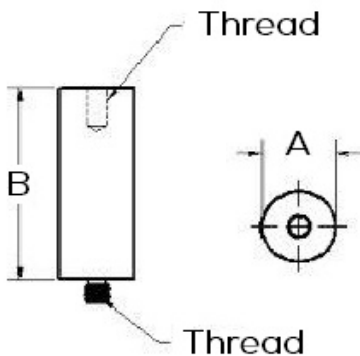

| Part Number | Thread | A | B |
|---------------------------------|--------|--------|-------|
| R20-2525-SO (No female thread) | 1/4-20 | 0.25" | 0.25" |
| R20-2550-SO (No female thread) | 1/4-20 | 0.25" | 0.50" |
| R20-251-SO (No female thread) | 1/4-20 | 0.25" | 1" |
| R20-37525-SO (No female thread) | 1/4-20 | 0.375" | 0.25" |
| R20-37550-SO | 1/4-20 | 0.375" | 0.50" |
| R20-37575-SO | 1/4-20 | 0.375" | 0.75" |
| R20-3751-SO | 1/4-20 | 0.375" | 1" |
| R20-5025-SO (No female thread) | 1/4-20 | 0.50" | 0.25" |
| R20-5050-SO | 1/4-20 | 0.50" | 0.50" |
| R20-5075-SO | 1/4-20 | 0.50" | 0.75" |
| R20-501-SO | 1/4-20 | 0.50" | 1" |
| R20-502-SO | 1/4-20 | 0.50" | 2" |
| R20-503-SO | 1/4-20 | 0.50" | 3" |
| R20-504-SO | 1/4-20 | 0.50" | 4" |
| R20-505-SO | 1/4-20 | 0.50" | 5" |
| R20-506-SO | 1/4-20 | 0.50" | 6" |
| R20-7550-SO | 1/4-20 | 0.75" | 0.50" |
| R20-7575-SO | 1/4-20 | 0.75" | 0.75" |
| R20-751-SO | 1/4-20 | 0.75" | 1" |
| R20-752-SO | 1/4-20 | 0.75" | 2" |
| R20-753-SO | 1/4-20 | 0.75" | 3" |
| R20-754-SO | 1/4-20 | 0.75" | 4" |
| R20-755-SO | 1/4-20 | 0.75" | 5" |
| R20-756-SO | 1/4-20 | 0.75" | 6" |
| R20-150-SO | 1/4-20 | 1" | 0.50" |
| R20-175-SO | 1/4-20 | 1" | 0.75" |
| R20-11-SO | 1/4-20 | 1" | 1" |
| R20-12-SO | 1/4-20 | 1" | 2" |
| R20-13-SO | 1/4-20 | 1" | 3" |
| R20-14-SO | 1/4-20 | 1" | 4" |
| R20-15-SO | 1/4-20 | 1" | 5" |
| R20-16-SO | 1/4-20 | 1" | 6" |

Standoffs Continued

| Part Number | Thread | A | B |
|------------------------------|--------|-------|--------|
| R8-1315-SO | M8 | 13 mm | 15 mm |
| R8-1320-SO | M8 | 13 mm | 20 mm |
| R8-1325-SO | M8 | 13 mm | 25 mm |
| R8-1350-SO | M8 | 13 mm | 50 mm |
| R8-1375-SO | M8 | 13 mm | 75 mm |
| R8-13100-SO | M8 | 13 mm | 100 mm |
| R8-13150-SO | M8 | 13 mm | 150 mm |
| R8-1915-SO | M8 | 19 mm | 15 mm |
| R8-1920-SO | M8 | 19 mm | 20 mm |
| R8-1925-SO | M8 | 19 mm | 25 mm |
| R8-1950-SO | M8 | 19 mm | 50 mm |
| R8-1975-SO | M8 | 19 mm | 75 mm |
| R8-19100-SO | M8 | 19 mm | 100 mm |
| R8-19150-SO | M8 | 19 mm | 150 mm |
| R8-2515-SO | M8 | 25 mm | 15 mm |
| R8-2520-SO | M8 | 25 mm | 20 mm |
| R8-2525-SO | M8 | 25 mm | 25 mm |
| R8-2550-SO | M8 | 25 mm | 50 mm |
| R8-25100-SO | M8 | 25 mm | 100 mm |
| R8-25150-SO | M8 | 25 mm | 150 mm |
| R8-3825-SO | M8 | 38 mm | 25 mm |
| R8-3850-SO | M8 | 38 mm | 50 mm |
| R8-38150-SO | M8 | 38 mm | 150 mm |
| R6-65-SO (No female thread) | M6 | 6 mm | 5 mm |
| R6-610-SO (No female thread) | M6 | 6 mm | 10 mm |
| R6-620-SO (No female thread) | M6 | 6 mm | 20 mm |
| R6-625-SO (No female thread) | M6 | 6 mm | 25 mm |
| R6-95-SO (No female thread) | M6 | 9 mm | 5 mm |
| R6-910-SO | M6 | 9 mm | 10 mm |
| R6-920-SO | M6 | 9 mm | 20 mm |
| R6-925-SO | M6 | 9 mm | 25 mm |
| R6-135-SO (No female thread) | M6 | 13 mm | 5 mm |
| R6-1310-SO | M6 | 13 mm | 10 mm |
| R6-1315-SO | M6 | 13 mm | 15 mm |
| R6-1320-SO | M6 | 13 mm | 20 mm |
| R6-1325-SO | M6 | 13 mm | 25 mm |
| R6-1350-SO | M6 | 13 mm | 50 mm |
| R6-1375-SO | M6 | 13 mm | 75 mm |
| R6-13100-SO | M6 | 13 mm | 100 mm |
| R6-13125-SO | M6 | 13 mm | 125 mm |
| R6-13150-SO | M6 | 19 mm | 150 mm |
| R6-1910-SO | M6 | 19 mm | 10 mm |
| R6-1915-SO | M6 | 19 mm | 15 mm |
| R6-1920-SO | M6 | 19 mm | 20 mm |
| R6-1925-SO | M6 | 19 mm | 25 mm |
| R6-1950-SO | M6 | 19 mm | 50 mm |
| R6-1975-SO | M6 | 19 mm | 75 mm |
| R6-19100-SO | M6 | 19 mm | 100 mm |
| R6-19125-SO | M6 | 19 mm | 125 mm |

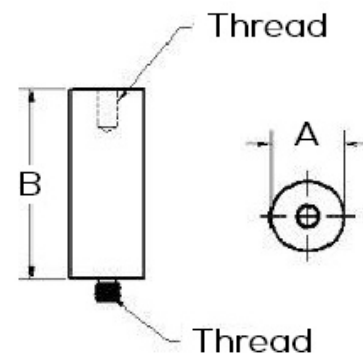

Standoffs Continued

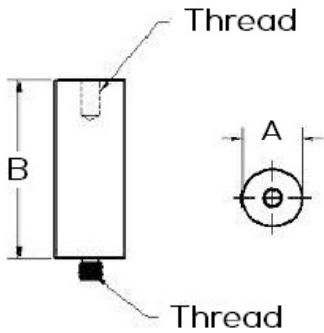

| Part Number | Thread | A | B |
|------------------------------|--------|-------|--------|
| R6-19150-SO | M6 | 19 mm | 150 mm |
| R6-2520-SO | M6 | 25 mm | 20 mm |
| R6-2525-SO | M6 | 25 mm | 25 mm |
| R6-2550-SO | M6 | 25 mm | 50 mm |
| R6-25100-SO | M6 | 25 mm | 100 mm |
| R6-25125-SO | M6 | 25 mm | 125 mm |
| R6-25150-SO | M6 | 25 mm | 150 mm |
| R4-65-SO (No female thread) | M4 | 6 mm | 5 mm |
| R4-610-SO (No female thread) | M4 | 6 mm | 10 mm |
| R4-620-SO (No female thread) | M4 | 6 mm | 20 mm |
| R4-625-SO (No female thread) | M4 | 6 mm | 25 mm |
| R4-95-SO (No female thread) | M4 | 9 mm | 5 mm |
| R4-910-SO | M4 | 9 mm | 10 mm |
| R4-920-SO | M4 | 9 mm | 20 mm |
| R4-925-SO | M4 | 9 mm | 25 mm |
| R4-125-SO (No female thread) | M4 | 12 mm | 5 mm |
| R4-1210-SO | M4 | 12 mm | 10 mm |
| R4-1220-SO | M4 | 12 mm | 20 mm |
| R4-1225-SO | M4 | 12 mm | 25 mm |

Pin Standoffs

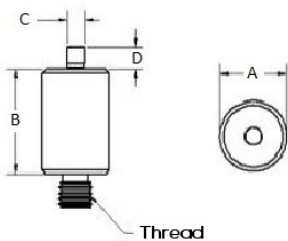

| Part Number | Thread | A | B | C | D |
|---------------|--------|--------|-------|--------|--------|
| R20-2525-PSO | 1/4-20 | 0.25" | 0.25" | 0.062" | 0.15" |
| R20-2550-PSO | 1/4-20 | 0.25" | 0.50" | 0.062" | 0.15" |
| R20-251-PSO | 1/4-20 | 0.25" | 1" | 0.062" | 0.15" |
| R20-37525-PSO | 1/4-20 | 0.375" | 0.25" | 0.062" | 0.15" |
| R20-37550-PSO | 1/4-20 | 0.375" | 0.50" | 0.062" | 0.15" |
| R20-3751-PSO | 1/4-20 | 0.375" | 1" | 0.062" | 0.15" |
| R20-5025-PSO | 1/4-20 | 0.50" | 0.25" | 0.062" | 0.15" |
| R20-5075-PSO | 1/4-20 | 0.50" | 0.75" | 0.125" | 0.15" |
| R20-501-PSO | 1/4-20 | 0.50" | 1" | 0.125" | 0.15" |
| R20-7575-PSO | 1/4-20 | 0.75" | 0.75" | 0.125" | 0.15" |
| R20-175-PSO | 1/4-20 | 1" | 0.75" | 0.125" | 0.15" |
| R20-11-PSO | 1/4-20 | 1" | 1" | 0.125" | 0.15" |
| R8-1320-PSO | M8 | 13 mm | 20 mm | 3.2 mm | 3.8 mm |
| R8-1325-PSO | M8 | 13 mm | 25 mm | 3.2 mm | 3.8 mm |
| R8-1920-PSO | M8 | 19 mm | 20 mm | 3.2 mm | 3.8 mm |
| R6-1320-PSO | M6 | 13 mm | 20 mm | 3.2 mm | 3.8 mm |
| R6-1325-PSO | M6 | 13 mm | 25 mm | 3.2 mm | 3.8 mm |
| R6-1920-PSO | M6 | 19 mm | 20 mm | 3.2 mm | 3.8 mm |
| R6-1925-PSO | M6 | 19 mm | 25 mm | 3.2 mm | 3.8 mm |
| R6-65-PSO | M6 | 6 mm | 5 mm | 2 mm | 3.8 mm |
| R6-610-PSO | M6 | 6 mm | 10 mm | 2 mm | 3.8 mm |
| R6-625-PSO | M6 | 6 mm | 25 mm | 2 mm | 3.8 mm |
| R6-95-PSO | M6 | 9 mm | 5 mm | 2 mm | 3.8 mm |
| R6-910-PSO | M6 | 9 mm | 10 mm | 2 mm | 3.8 mm |
| R6-925-PSO | M6 | 9 mm | 25 mm | 2 mm | 3.8 mm |

| Part Number | Thread | A | B | C | D |
|-------------|--------|-------|-------|------|--------|
| R4-65-PSO | M4 | 6 mm | 5 mm | 2 mm | 3.8 mm |
| R4-610-PSO | M4 | 6 mm | 10 mm | 2 mm | 3.8 mm |
| R4-625-PSO | M4 | 6 mm | 25 mm | 2 mm | 3.8 mm |
| R4-95-PSO | M4 | 9 mm | 5 mm | 2 mm | 3.8 mm |
| R4-910-PSO | M4 | 9 mm | 10 mm | 2 mm | 3.8 mm |
| R4-925-PSO | M4 | 9 mm | 25 mm | 2 mm | 3.8 mm |
| R4-125-PSO | M4 | 12 mm | 5 mm | 2 mm | 3.8 mm |
| R4-1210-PSO | M4 | 12 mm | 10 mm | 2 mm | 3.8 mm |
| R4-1225-PSO | M4 | 12 mm | 25 mm | 2 mm | 3.8 mm |

Pin Standoffs Continued



| Part Number | Thread | A | B | C | D |
|--------------|--------|-------|------------|-------------|-------------|
| R20-502-SLTP | 1/4-20 | 2" | 0.50" Dia. | 0.250" Dia. | 0.045" Rad. |
| R20-752-SLTP | 1/4-20 | 2" | 0.75" Dia. | 0.375" Dia. | 0.125" Rad. |
| R8-1350-SLTP | M8 | 50 mm | 13 mm Dia. | 6 mm Dia. | 1 mm Rad. |
| R8-1950-SLTP | M8 | 50 mm | 19 mm Dia. | 9 mm Dia. | 3mm Rad. |
| R6-1350-SLTP | M6 | 50 mm | 13 mm Dia. | 9 mm Dia. | 3mm Rad. |
| R6-1950-SLTP | M6 | 50 mm | 19 mm Dia. | 16 mm Dia. | 6mm Rad. |

Spring Loaded Tapered Pin Standoffs

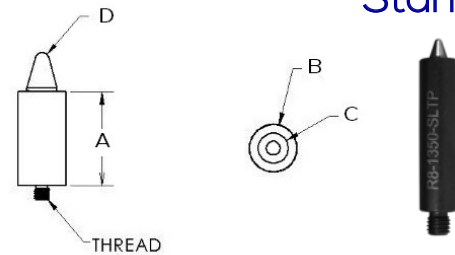

| Part Number | Thread | A | B | C |
|---------------|--------|-------|------------|-------------|
| R20-5075-RPSO | 1/4-20 | 0.75" | 0.50" Dia. | 0.250" Dia. |
| R20-501-RPSO | 1/4-20 | 1" | 0.50" Dia. | 0.250" Dia. |
| R8-1320-RPSO | M8 | 20 mm | 13 mm Dia. | 6.3 mm Dia. |
| R8-1325-RPSO | M8 | 25 mm | 13 mm Dia. | 6.3mm Dia. |
| R6-1320-RPSO | M6 | 20 mm | 13 mm Dia. | 6.3 mm Dia. |
| R6-1325-RPSO | M6 | 25 mm | 13 mm Dia. | 6.3 mm Dia. |

Rounded Pin Standoffs

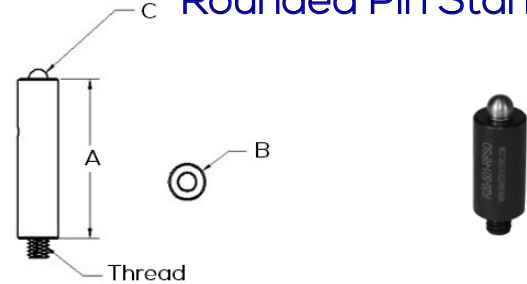

| Part Number | Thread | A | B | C |
|--------------|--------|-------|------------|-------------|
| R20-502-SLRP | 1/4-20 | 2" | 0.50" Dia. | 0.250" Dia. |
| R20-752-SLRP | 1/4-20 | 2" | 0.75" Dia. | 0.375" Dia. |
| R8-1350-SLRP | M8 | 50 mm | 13 mm Dia. | 6.3 mm Dia. |
| R8-1950-SLRP | M8 | 50 mm | 19 mm Dia. | 9.5 mm Dia. |
| R6-1350-SLRP | M6 | 50 mm | 13 mm Dia. | 6.3 mm Dia. |
| R6-1950-SLRP | M6 | 50 mm | 19 mm Dia. | 9.5 mm Dia. |

Spring Loaded Rounded Pin Standoffs

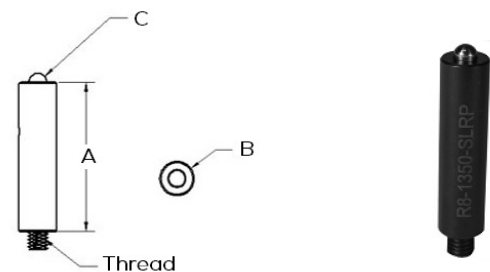

| Part Number | Thread | A | B | C | D |
|--------------|--------|-------|-------|--------|--------|
| R20-5050-SPS | 1/4-20 | 0.50" | 0.50" | 0.069" | 0.008" |
| R20-751-SPS | 1/4-20 | 0.75" | 1" | 0.168" | 0.027" |
| R8-1925-SPS | M8 | 19 mm | 25 mm | 4.3 mm | 0.7 mm |
| R6-1310-SPS | M6 | 13 mm | 10 mm | 1.8 mm | 0.2 mm |
| R6-1925-SPS | M6 | 19 mm | 25 mm | 4.3 mm | 0.2 mm |
| R4-1210-SPS | M4 | 12 mm | 10 mm | 1.8 mm | 0.2 mm |

Spring Locating Pin Standoffs

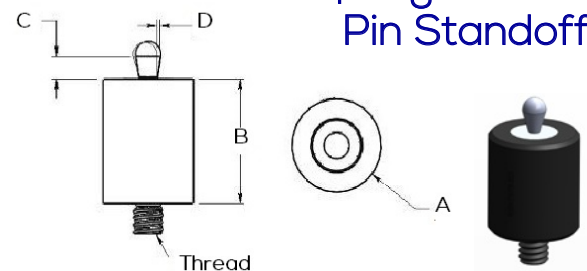

*Optional pin material and side forces available

Rotational Spring Locating Pin Standoff

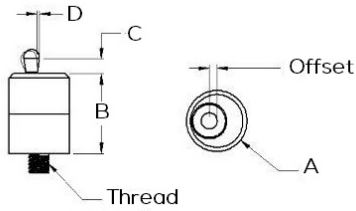

| Part Number | Thread | A | B | C | D |
|-------------|--------|-------|-------|--------|--------|
| R20-75-CSPS | 1/4-20 | 0.75" | 1" | 0.168" | 0.027" |
| R8-19-CSPS | M8 | 19 mm | 25 mm | 4.3 mm | 0.7 mm |
| R6-19-CSPS | M6 | 19 mm | 25 mm | 4.3 mm | 0.7 mm |
| R4-19-CSPS | M4 | 19 mm | 25 mm | 4.3 mm | 0.7 mm |

*Optional pin material and side forces available

Magnetic Standoffs

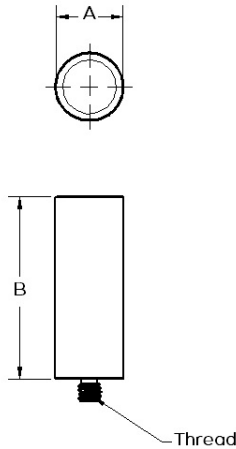

| Part Number | Thread | A | B |
|-------------|--------|-------|-------|
| R20-50-M | 1/4-20 | 0.50" | 1" |
| R20-75-M | 1/4-20 | 0.75" | 1" |
| R20-1-M | 1/4-20 | 1" | 1" |
| R20-125-M | 1/4-20 | 1.25" | 1" |
| R8-13-M | M8 | 13 mm | 25 mm |
| R8-19-M | M8 | 19 mm | 25 mm |
| R8-25-M | M8 | 25 mm | 25 mm |
| R8-32-M | M8 | 32 mm | 25 mm |
| R6-13-M | M6 | 13 mm | 25 mm |
| R6-19-M | M6 | 19 mm | 25 mm |
| R6-25-M | M6 | 25 mm | 25 mm |
| R4-6-M | M4 | 6 mm | 25 mm |
| R4-13-M | M4 | 13 mm | 25 mm |

Magnetic Pin Standoffs

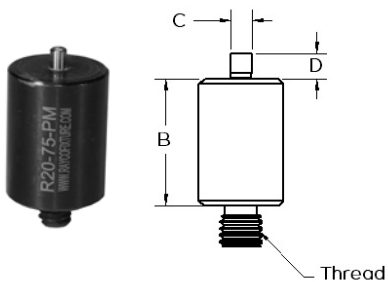

| Part Number | Thread | A | B | C | D |
|-------------|--------|-------|-------|--------|--------|
| R20-50-PM | 1/4-20 | 0.50" | 1" | 0.125" | 0.150" |
| R20-75-PM | 1/4-20 | 0.75" | 1" | 0.125" | 0.150" |
| R20-1-PM | 1/4-20 | 1" | 1" | 0.125" | 0.150" |
| R8-13-PM | M8 | 13 mm | 25 mm | 3 mm | 3.8 mm |
| R8-19-PM | M8 | 19 mm | 25 mm | 3 mm | 3.8 mm |
| R8-25-PM | M8 | 25 mm | 25 mm | 3 mm | 3.8 mm |
| R6-13-PM | M6 | 13 mm | 25 mm | 3 mm | 3.8 mm |
| R6-19-PM | M6 | 19 mm | 25 mm | 3 mm | 3.8 mm |
| R6-25-PM | M6 | 25 mm | 25 mm | 3 mm | 3.8 mm |
| R4-6-PM | M4 | 6 mm | 25 mm | 2 mm | 3.8 mm |
| R4-13-PM | M4 | 13 mm | 25 mm | 2 mm | 3.8 mm |

| Part Number | Thread | A | B | C | D |
|-------------|--------|-------|-------|-------|-------|
| R20-50-VMB | 1/4-20 | 0.50" | 3" | 1" | 1.50" |
| R20-75-VMB | 1/4-20 | 0.75" | 3" | 1" | 1.50" |
| R20-1-VMB | 1/4-20 | 1" | 3" | 1" | 1.50" |
| R20-125-VMB | 1/4-20 | 1.25" | 3" | 1" | 1.50" |
| R8-13-VMB | M8 | 13 mm | 75 mm | 25 mm | 36 mm |
| R8-19-VMB | M8 | 19 mm | 75 mm | 25 mm | 36 mm |
| R8-25-VMB | M8 | 25 mm | 75 mm | 25 mm | 36 mm |
| R8-32-VMB | M8 | 32 mm | 75 mm | 25 mm | 36 mm |
| R6-13-VMB | M6 | 13 mm | 75 mm | 25 mm | 36 mm |
| R6-19-VMB | M6 | 19 mm | 75 mm | 25 mm | 36 mm |
| R6-25-VMB | M6 | 25 mm | 75 mm | 25 mm | 36 mm |

V-Magnets with Base

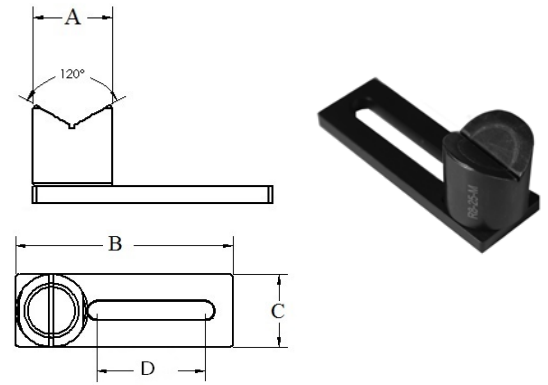

| Part Number | Thread | A | B |
|-------------|--------|-------|-------|
| R20-50-VM | 1/4-20 | 0.50" | 1" |
| R20-75-VM | 1/4-20 | 0.75" | 1" |
| R20-1-VM | 1/4-20 | 1" | 1" |
| R20-125-VM | 1/4-20 | 1.25" | 1" |
| R8-13-VM | M8 | 13 mm | 25 mm |
| R8-19-VM | M8 | 19 mm | 25 mm |
| R8-25-VM | M8 | 25 mm | 25 mm |
| R8-32-VM | M8 | 32 mm | 25 mm |
| R6-13-VM | M6 | 13 mm | 25 mm |
| R6-19-VM | M6 | 19 mm | 25 mm |
| R6-25-VM | M6 | 25 mm | 25 mm |

V-Magnets

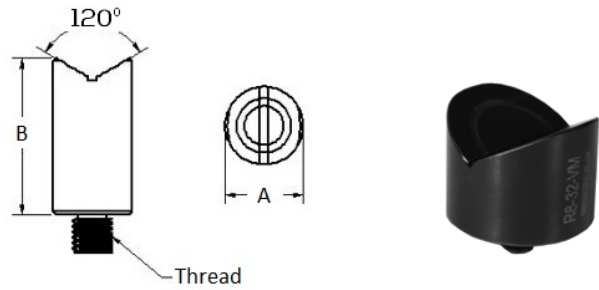

| Part Number | Thread | A | B | C |
|-------------|--------|-------|-------|-------|
| R20-11-RS | 1/4-20 | 1" | 0.50" | 1" |
| R6-2525-RS | M6 | 25 mm | 13 mm | 25 mm |

Rotating Standoffs*

* Used for holding parts against stop

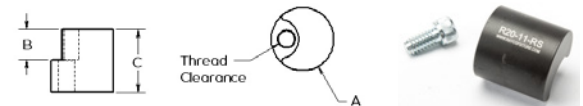

| Part Number | Thread 1 | A | B | Thread 2 |
|-------------|----------|-------|-------|----------|
| R20-6-SOA | 1/4-20 | 1" | 1" | M6 |
| R20-8-SOA | 1/4-20 | 1" | 1" | M8 |
| R20-10-SOA | 1/4-20 | 1" | 1" | M10 |
| R20-12-SOA | 1/4-20 | 1" | 1" | M12 |
| R20-516-SOA | 1/4-20 | 1" | 1" | 5/16-18 |
| R20-38-SOA | 1/4-20 | 1" | 1" | 3/8-16 |
| R8-14-SOA | M8 | 25 mm | 25 mm | 1/4-20 |
| R6-20-SOA | M6 | 25 mm | 25 mm | 1/4-20 |
| R6-8-SOA | M6 | 25 mm | 25 mm | M8 |
| R4-14-SOA | M4 | 19 mm | 15 mm | 1/4-20 |

Standoff Adapters

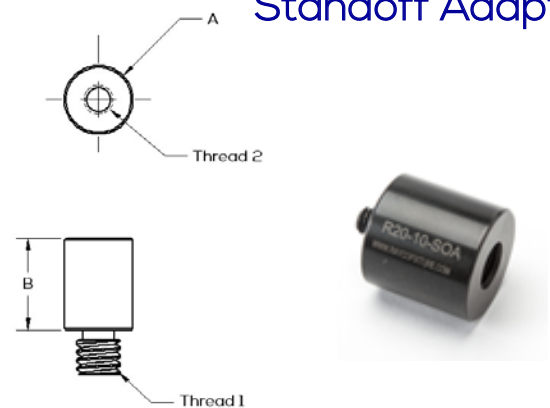

Adjustable Height Stands

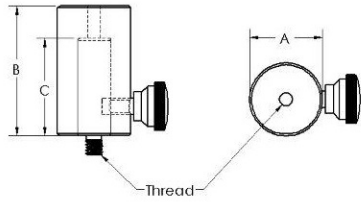

| Part Number | Thread | A | B | C |
|-------------|--------|---------|-------|-------|
| R20-AHS | 1/4-20 | 1.125" | 2" | 1.5" |
| R8-AHS | M8 | 28.5 mm | 50 mm | 38 mm |
| R6-AHS | M6 | 28.5 mm | 50 mm | 38mm |

Adjustable V-Height Stands

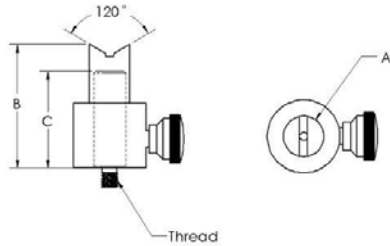

| Part Number | Thread | A | B | C |
|-------------|--------|--------|---------|-------|
| R20-50-AHVS | 1/4-20 | 0.625" | 1.9" | 1.5" |
| R20-1-AHVS | 1/4-20 | 1.125" | 2" | 1.5" |
| R8-12-AHVS | M8 | 16 mm | 48.5 mm | 38 mm |
| R8-25-AHVS | M8 | 25 mm | 50 mm | 38 mm |
| R6-12-AHVS | M6 | 16 mm | 48.5 mm | 38 mm |
| R6-25-AHVS | M6 | 25 mm | 50 mm | 38 mm |

Adjustable T-Arms

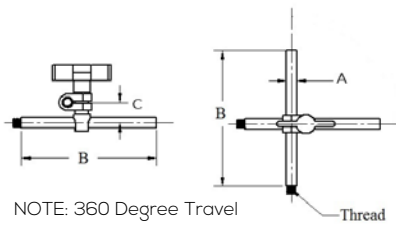

NOTE: 360 Degree Travel

| Part Number | Thread | A | B | C |
|-------------|--------|---------|--------|-------|
| R20-AA | 1/4-20 | 0.3125" | 4" | 0.6" |
| R8-AA | M8 | 8 mm | 100 mm | 15 mm |
| R6-AA | M6 | 8 mm | 100 mm | 15 mm |

Resting Pins

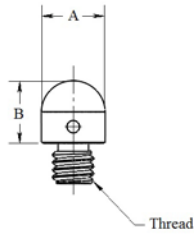

| Part Number | Thread | A | B | Material |
|-------------|--------|--------|--------|----------|
| R20-SRP | 1/4-20 | 0.375" | 0.375" | Steel |
| R8-SRP | M8 | 13 mm | 12 mm | Steel |
| R6-SRP | M6 | 9.5 mm | 9.5 mm | Steel |
| R4-ARP | M4 | 6.3 mm | 5 mm | Aluminum |

Cones

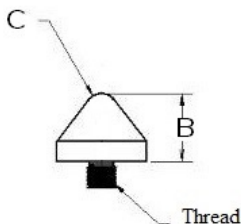
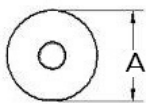

| Part Number | Thread | A | B | C | Material |
|-------------|--------|--------|-------|---------|----------|
| R20-NC | 1/4-20 | 0.625" | 0.50" | 0.156" | Nylon |
| R20-SC | 1/4-20 | 0.625" | 0.50" | 0.156" | Steel |
| R20-AC | 1/4-20 | 1" | 0.75" | 0.1875" | Aluminum |
| R8-NC | M8 | 16 mm | 13 mm | 4 mm | Nylon |
| R8-NC-L | M8 | 25 mm | 19 mm | 4.8 mm | Nylon |
| R8-SC | M8 | 16 mm | 13 mm | 4 mm | Steel |
| R8-AC | M8 | 25 mm | 19 mm | 4.8 mm | Aluminum |
| R6-NC | M6 | 16 mm | 13 mm | 4 mm | Nylon |
| R6-NC-L | M6 | 25 mm | 19 mm | 4.8 mm | Nylon |
| R6-SC | M6 | 16 mm | 13 mm | 4 mm | Steel |
| R6-AC | M6 | 25 mm | 19 mm | 4.8 mm | Aluminum |

Tension Spring Brackets

| Part Number | Thread | A | B | C | D |
|-------------|--------|-------|---------|---------|---------|
| R20-75-TSB | 1/4-20 | 0.75" | 1.40" | 2.240" | 3.110" |
| R20-1-TSB | 1/4-20 | 1" | 1.40" | 2.240" | 3.235" |
| R8-19-TSB | M8 | 19 mm | 35.6 mm | 56.9 mm | 79 mm |
| R8-25-TSB | M8 | 25 mm | 35.6 mm | 56.9 mm | 82.2 mm |
| R6-19-TSB | M6 | 19 mm | 35.6 mm | 56.9 mm | 79 mm |
| R6-25-TSB | M6 | 25 mm | 35.6 mm | 56.9 mm | 82.2 mm |

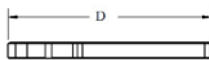
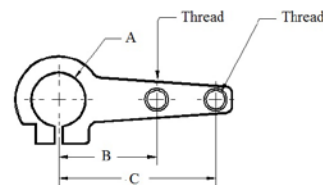

| Part Number | Thread | A | B | C | D |
|-------------|--------|--------|--------|-------|-------|
| R20-CTB-1 | 1/4-20 | 3.375" | 1.273" | 1" | 1.19" |
| R8-CTB-25 | M8 | 86 mm | 32 mm | 25 mm | 30 mm |
| R6-CTB-25 | M6 | 86 mm | 32 mm | 25 mm | 30 mm |

Adjustable Tension Spring Bracket

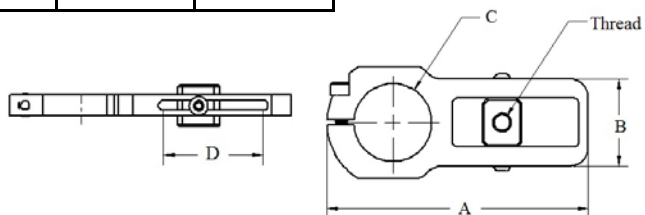

| Part Number | Thread | A | B | C | D | Material |
|-------------|--------|---------|---------|---------|--------|----------|
| R20-SLD | 1/4-20 | 3" | 1" | 1.545" | 0.250" | Steel |
| R20-MSLD | 1/4-20 | 1.375" | 0.626" | 0.563" | 0.250" | Aluminum |
| R20-ASLD | 1/4-20 | 2" | 0.625" | 1.25" | 0.250" | Acrylic |
| R8-SLD | M8 | 65 mm | 20 mm | 32 mm | 10 mm | Steel |
| R6-SLD | M6 | 75 mm | 25 mm | 40 mm | 10 mm | Steel |
| R6-MSLD | M6 | 35 mm | 16 mm | 15 mm | 10 mm | Aluminum |
| R6-ASLD | M6 | 50 mm | 15.9 mm | 31.8 mm | 6 mm | Acrylic |
| R4-MSLD | M4 | 30 mm | 12 mm | 11 mm | 5 mm | Aluminum |
| R4-ASLD | M4 | 38.1 mm | 12.7 mm | 20.6 mm | 5 mm | Acrylic |

Slide Bases

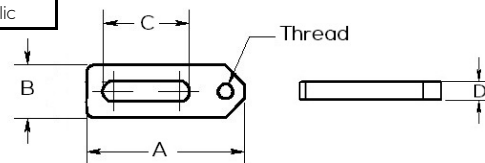

| Part Number | Thread | A | B | C |
|-----------------|--------|-------|---------|-------|
| R20-LB | 1/4-20 | 0.75" | 2.625" | 1.25" |
| R20-LB-B (Base) | 1/4-20 | 0.75" | 2.625" | n/a |
| R8-LB | M8 | 25 mm | 85 mm | 40 mm |
| R8-LB-B (Base) | M8 | 25 mm | 85 mm | n/a |
| R6-LB | M6 | 19 mm | 66.7 mm | 32 mm |
| R6-LB-B (Base) | M6 | 19 mm | 66.7 mm | n/a |
| R4-LB | M4 | 16 mm | 42 mm | 24 mm |
| R4-LB-B (Base) | M4 | 16 mm | 42 mm | n/a |

Locating Blocks

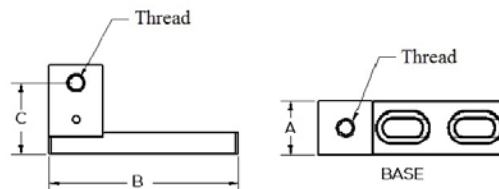

Spring Holding Devices

| Part Number | Thread | A | B | C | D |
|-------------|--------|-------|-------|-------|-------|
| R20-SHD | 1/4-20 | 0.5" | 1" | 1.75" | 1.74" |
| R8-SHD | M8 | 13 mm | 25 mm | 44 mm | 44 mm |
| R6-SHD | M6 | 13 mm | 25 mm | 44 mm | 44 mm |

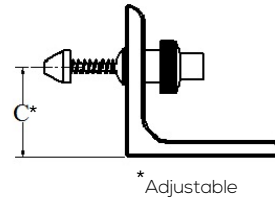
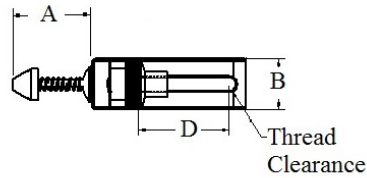

Pusher Clamp

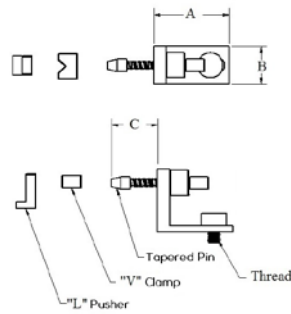

| Part Number | Thread | A | B | C |
|-------------|--------|-------|-------|--------|
| R20-PC | 1/4-20 | 1.5" | 0.75" | 0.15" |
| R6-PC | M6 | 38 mm | 19 mm | 3.8 mm |
| R4-PC | M4 | 38 mm | 19 mm | 3.8 mm |

Spring Loaded Pusher Clamp

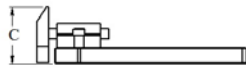
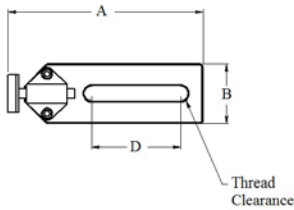

| Part Number | Thread | A | B | C | D |
|-------------|--------|-------|-------|---------|-------|
| R20-SLPC | 1/4-20 | 3.25" | 1" | 0.90" | 1.75" |
| R8-SLPC | M8 | 83 mm | 25 mm | 22.8 mm | 44 mm |
| R6-SLPC | M6 | 83 mm | 25 mm | 22.8 mm | 44 mm |

Adjustable Jackstands

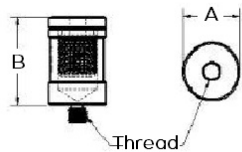

| Part Number | Thread | A | B | Height Adjustment |
|-------------|--------|--------|---------|-------------------|
| R20-50-JS | 1/4-20 | 0.625" | 15" | 0.500" |
| R20-1-JS | 1/4-20 | 1" | 15" | 0.500" |
| R8-19-JS | M8 | 19 mm | 38 mm | 13 mm |
| R8-25-JS | M8 | 25 mm | 38 mm | 13 mm |
| R6-13-JS | M6 | 13 mm | 38 mm | 13 mm |
| R6-25-JS | M6 | 25 mm | 38 mm | 13 mm |
| R4-MJS | M4 | 9.5 mm | 20.2 mm | 5 mm |

Tooling Balls

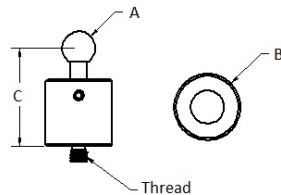

| Part Number | Thread | A | B | C |
|-------------|--------|---------|-------|---------|
| R20-50-TB | 1/4-20 | 0.5" | 1" | 1.5" |
| R8-12-TB | M8 | 12.7 mm | 25 mm | 38.1 mm |
| R6-12-TB | M6 | 12.7 mm | 25 mm | 38.1 mm |

| Part Number | Thread | A | B | C | D |
|-------------|--------|----------|---------|---------|---------|
| R20-SDC | 1/4-20 | 3.6" | 0.15" | 1" | 0.6" |
| R20-LDC | 1/4-20 | 5.030" | 0.48" | 15" | 2.03" |
| R8-SDC | M8 | 25.4 mm | 3.8 mm | 25.4 mm | 15.2 mm |
| R8-LDC | M8 | 127.8 mm | 12.2 mm | 38.1 mm | 51.6 mm |
| R6-SDC | M6 | 91.4 mm | 3.8 mm | 25.4 mm | 15.2 mm |
| R6-LDC | M6 | 127.8 mm | 12.2 mm | 38.1 mm | 51.6 mm |

Hold Down Clamps

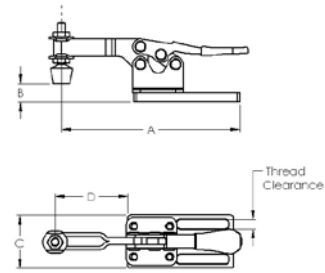

| Part Number | Thread | A | B | C |
|-------------|--------|--------|----------|-------|
| R20-CJ3 | 1/4-20 | 5" | 7" | 3.75" |
| R8-CJ3 | M8 | 127 mm | 177.8 mm | 95 mm |
| R6-CJ3 | M6 | 127 mm | 177.8 mm | 95 mm |

3 Jaw Chucks

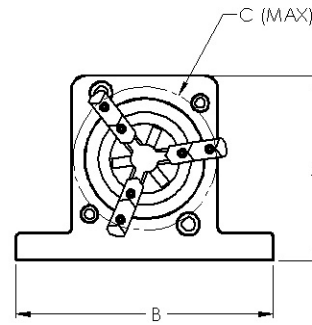
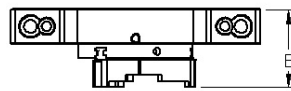

| Part Number | Thread | A | B | C | D |
|-------------|--------|----------|----------|---------|-------|
| R20-CJ3-R | 1/4-20 | 4" | 2.727" | 15" | 2.32" |
| R8-CJ3-R | M8 | 101.6 mm | 69.27 mm | 38.1 mm | 59 mm |
| R6-CJ3-R | M6 | 101.6 mm | 69.27 mm | 38.1 mm | 59 mm |

Rotational 3 Jaw Chucks

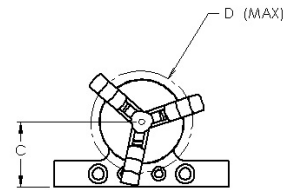
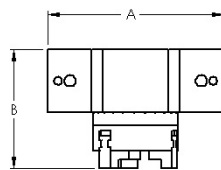

| Part Number | Thread | A | B | C | Max Opening |
|-------------|--------|-------|-----------|-------|-------------|
| R20-MV-2125 | 1/4-20 | 2.4" | 4.40" | 1.75" | 2.2" |
| R8-MV-2125 | M8 | 61 mm | 111.75 mm | 44 mm | 55.90 mm |
| R6-MV-2125 | M6 | 61 mm | 111.75 mm | 44 mm | 55.90 mm |

Vices

*Optional Rotational Base Available

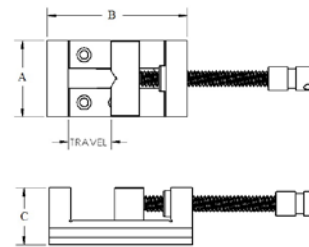

| Part Number | A | B | C | Max Opening |
|-------------|--------|-------|-------|-------------|
| R-MV-A | 0.625" | 1.69" | 1.6" | 0.84" |
| R-MV-B | 0.625" | 2" | 1.78" | 0.84" |

Offered in 1/4-20, M6 and M4 thread

Mini Vices

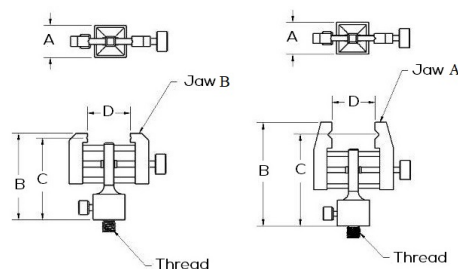

Small Vice Clamp

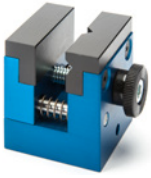

*Standard SVC is supplied with plastic jaws as show

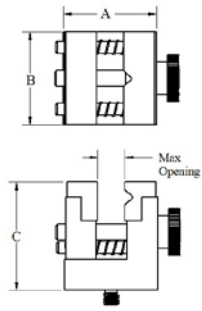

| Part Number | Thread | A | B | C | Max Opening |
|-------------|--------|-------|-------|---------|-------------|
| R20-SVC | 1/4-20 | 1.5" | 1.5" | 1.75" | 0.45" |
| R8-SVC | M8 | 38 mm | 38 mm | 44.5 mm | 11 mm |
| R6-SVC | M6 | 38 mm | 38 mm | 44.5 mm | 11 mm |
| R4-SVC | M4 | 38 mm | 38 mm | 44.5 mm | 11 mm |

*Jaw Material: Plastic, Aluminum and Steel

*Jaw Design: Horizontal or Vertical V-notch

Stepped (to control seated depth of clamp part)

90 Degree Angle Brackets

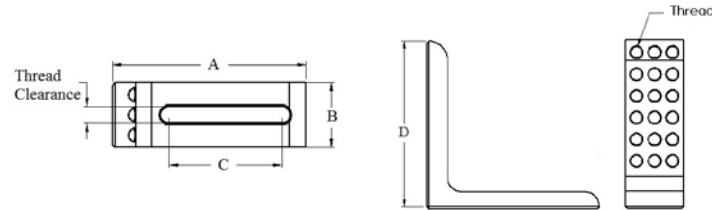

| Part Number | Thread | A | B | C | D |
|-------------------|--------|-------|-------|----------|---------|
| R20-90L2 (2 rows) | 1/4-20 | 3" | 1" | 1.75" | 3" |
| R20-90L3 (3 rows) | 1/4-20 | 3" | 1" | 1.75" | 3" |
| R8-90L2 (2 rows) | M8 | 76 mm | 25mm | 44.45 mm | 76.2 mm |
| R6-90L2 (2 rows) | M6 | 76 mm | 25 mm | 44.45 mm | 76.2 mm |
| R6-90L3 (3 rows) | M6 | 76 mm | 25 mm | 44.45 mm | 76.2 mm |
| R4-90L4 (4 rows) | M4 | 76 mm | 25 mm | 44.45 mm | 76.2 mm |

Vertical Plates



Numbers in the X-Axis & Letters in the Z-Axis.

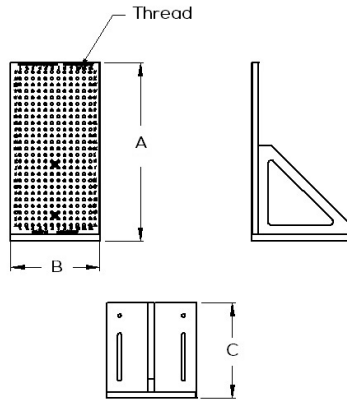

| Part Number | Thread | A | B | C |
|-----------------|--------|--------|--------|--------|
| R20-3250-50-VP | 1/4-20 | 3" | 2" | 2" |
| R20-125-VP | 1/4-20 | 12" | 5" | 6" |
| R20-147-VP | 1/4-20 | 14" | 7" | 7.5" |
| R20-2010-VP | 1/4-20 | 20" | 10" | 8" |
| R8-300125-VP | M8 | 300 mm | 125 mm | 127 mm |
| R8-350180-VP | M8 | 350 mm | 180 mm | 180 mm |
| R8-500250-VP | M8 | 500 mm | 250 mm | 203 mm |
| R8-755013-10-VP | M8 | 75 mm | 50 mm | 50 mm |
| R6-300125-VP | M6 | 300 mm | 125 mm | 127 mm |
| R6-350180-VP | M6 | 350 mm | 180 mm | 180 mm |
| R6-500250-VP | M6 | 500 mm | 250 mm | 203 mm |
| R6-755013-10-VP | M6 | 75 mm | 50 mm | 50 mm |
| R4-507513-10-VP | M4 | 50 mm | 75 mm | 38 mm |

Adjustable Angle Plate

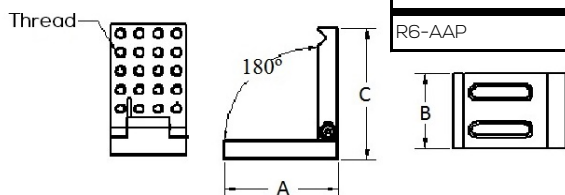

| Part Number | Thread | A | B | C |
|-------------|--------|-------|-------|---------|
| R20-AAP | 1/4-20 | 3" | 2" | 3.5" |
| R8-AAP | M8 | 75 mm | 50 mm | 88.9 mm |
| R6-AAP | M6 | 75 mm | 50 mm | 88.9 mm |

| Part Number | Thread | A | B | C |
|--------------|--------|--------|-----------|----------|
| R20-16-MT4 | 1/4-20 | 6" | 1" sq. | 5" |
| R20-112-MT4 | 1/4-20 | 12" | 1" sq. | 5" |
| R20-1512-MT4 | 1/4-20 | 12" | 1.5" sq. | 6" |
| R20-1518-MT4 | 1/4-20 | 18" | 1.5" sq. | 6" |
| R20-224-MT4 | 1/4-20 | 24" | 2" sq. | 6" |
| R20-230-MT4 | 1/4-20 | 30" | 2" sq. | 6" |
| R8-25150-MT4 | M8 | 150 mm | 25 mm sq. | 127 mm |
| R8-25300-MT4 | M8 | 300 mm | 25 mm sq. | 127 mm |
| R8-38300-MT4 | M8 | 300 mm | 38 mm sq. | 152.4 mm |
| R8-38450-MT4 | M8 | 450 mm | 38 mm sq. | 152.4 mm |
| R8-50600-MT4 | M8 | 600 mm | 50 mm sq. | 152.4 mm |
| R8-50750-MT4 | M8 | 750 mm | 50 mm sq. | 152.4 mm |
| R6-25150-MT4 | M6 | 150 mm | 25 mm sq. | 127 mm |
| R6-25300-MT4 | M6 | 300 mm | 25 mm sq. | 127 mm |

Mini Towers

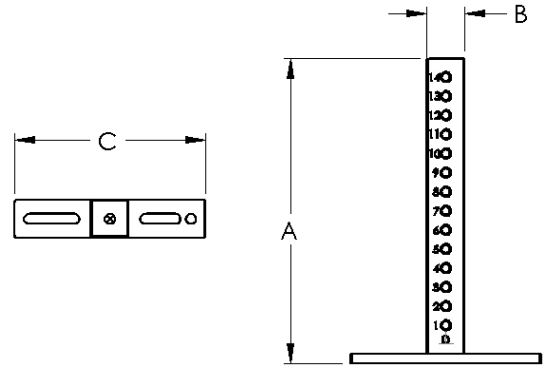

| Part Number | Thread | A | B | C | D |
|-------------|--------|----------|---------|----------|---------|
| R20-MCV | 1/4-20 | 1.75" | 0.5" | 1.75" | 0.25" |
| R20-CV | 1/4-20 | 3.25" | 0.75" | 3.25" | 0.25" |
| R8-MCV | M8 | 50 mm | 19 mm | 50 mm | 9.5 mm |
| R8-CV | M8 | 82.5 mm | 19 mm | 82.5 mm | 9.5 mm |
| R6-MCV | M6 | 44.43 mm | 12.7 mm | 44.43 mm | 6.30 mm |
| R6-CV | M6 | 75.2 mm | 19 mm | 75.2 mm | 6.30 mm |
| R4-MCV | M4 | 30 mm | 10 mm | 30 mm | 5 mm |
| R4-CV | M4 | 50 mm | 10 mm | 50 mm | 5 mm |

Corner Viewer

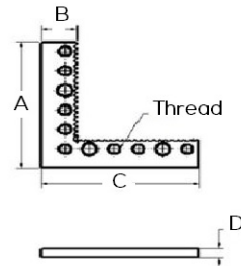

| Part Number | Thread | A | B |
|-------------|--------|----------|---------|
| R20-PJ | 1/4-20 | 1125" | 150" |
| R8-PJ | M8 | 28.60 mm | 38.1 mm |
| R6-PJ | M6 | 28.60 mm | 38.1 mm |

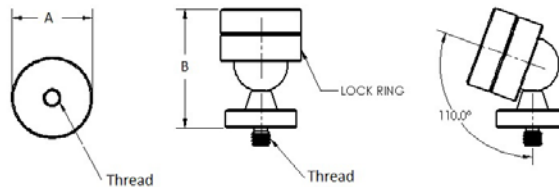

Pivot Joints



| Part Number | Thread | A | B |
|-------------|--------|-------|---------|
| R20-APJ | 1/4-20 | 0.75" | 1.70" |
| R8-APJ | M8 | 19 mm | 43.2 mm |
| R6-APJ | M6 | 19 mm | 43.2 mm |

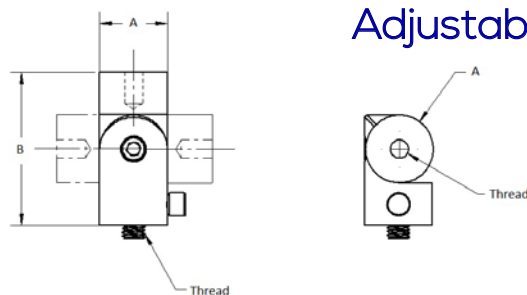

Adjustable Pivot Joints



Acrylic V-Blocks



| Part Number | Thread | A | B | C | D |
|-------------|--------|-------|-------|------------|-------|
| RA20-5-V | 1/4-20 | 2" | 1" | 0.75" REF. | 0.5" |
| RA6-13-V | M6 | 50 mm | 25 mm | 19 mm REF. | 13 mm |
| RA4-6-V | M4 | 50 mm | 25 mm | 19 mm REF. | 16 mm |
| RA4-13-V | M4 | 50 mm | 25 mm | 19 mm REF. | 13 mm |

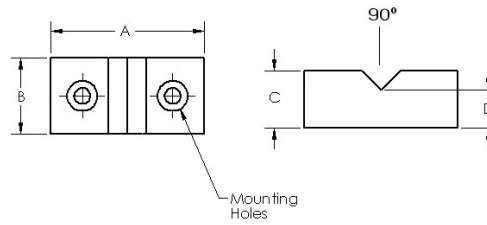

Slide Base with Mirror

| Part Number | Thread | A | B | C | D |
|-------------|--------|-------|---------|--------|---------|
| R20-SLDM | 1/4-20 | 3" | 0.8" | 1.375" | 0.99" |
| R6-SLDM | M6 | 75 mm | 20.3 mm | 35 mm | 25.2 mm |
| R4-SLDM | M4 | 75 mm | 20.3 mm | 35 mm | 25.2 mm |

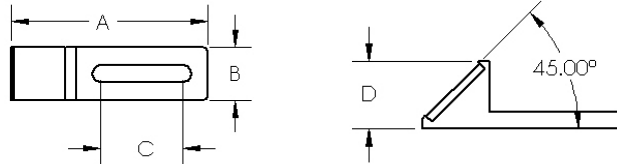
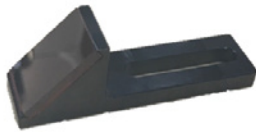

Male Centers



| Part Number | Thread | A | B | C | D |
|-------------|--------|---------|---------|---------|----------|
| R20-25-C | 1/4-20 | 0.25" | 2" | 0.875" | 2" |
| R20-50-C | 1/4-20 | 0.5" | 2.5" | 1" | 4" |
| R20-1-C | 1/4-20 | 1" | 2.5" | 1" | 4" |
| R8-6-C | M8 | 6.35 mm | 50.8 mm | 22.2 mm | 50 mm |
| R8-13-C | M8 | 12.7 mm | 63.5 mm | 25.4 mm | 101.6 mm |
| R8-25-C | M8 | 25.4 mm | 63.5 mm | 25.4 mm | 101.6 mm |
| R6-6-C | M6 | 6.35 mm | 50.8 mm | 22.2 mm | 50 mm |
| R6-13-C | M6 | 12.7 mm | 63.5 mm | 25.4 mm | 101.6 mm |
| R6-25-C | M6 | 25.4 mm | 63.5 mm | 25.4 mm | 101.6 mm |

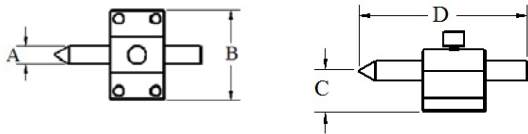

Mini Male Center

| Part Number | Thread | A | B | C | D |
|-------------|--------|-------|-------|------|-------|
| R4-MC | M4 | 32 mm | 50 mm | 8 mm | 33 mm |

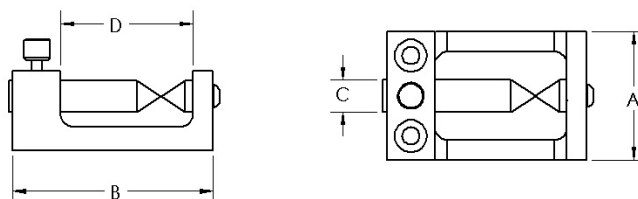

| Part Number | Thread | A | B | C |
|-------------|--------|-------|---------|---------|
| R20-5-MS | 1/4-20 | 5 mm | 0.438" | 1.378" |
| R20-10-SC | 1/4-20 | 10 mm | 0.63" | 1.75" |
| R20-15-SC | 1/4-20 | 15 mm | 0.875" | 1.75" |
| R20-20-SC | 1/4-20 | 20 mm | 1.125" | 1.75" |
| R20-30-SC | 1/4-20 | 30 mm | 1.6" | 2.5" |
| R20-50-SC | 1/4-20 | 50 mm | 2.5" | 2.5" |
| R8-10-SC | M8 | 10 mm | 16 mm | 44.5 mm |
| R8-15-SC | M8 | 15 mm | 22.2 mm | 44.5 mm |
| R8-20-SC | M8 | 20 mm | 28.6 mm | 44.5 mm |
| R8-30-SC | M8 | 30 mm | 41.7 mm | 63.5 mm |
| R8-50-SC | M8 | 50 mm | 64 mm | 63.5 mm |
| R6-5-SC | M6 | 5 mm | 11.3 mm | 35 mm |
| R6-10-SC | M6 | 10 mm | 16 mm | 44.5 mm |
| R6-15-SC | M6 | 15 mm | 22.2 mm | 44.5 mm |
| R6-20-SC | M6 | 20 mm | 28.6 mm | 44.5 mm |
| R6-30-SC | M6 | 30 mm | 41.7 mm | 63.5 mm |
| R6-50-SC | M6 | 50 mm | 64 mm | 63.5 mm |
| R4-5-SC | M4 | 5 mm | 11.3 mm | 35 mm |
| R4-10-SC | M4 | 10 mm | 16 mm | 44.5 mm |
| R4-15-SC | M4 | 15 mm | 22.2 mm | 44.5 mm |
| R4-20-SC | M4 | 20 mm | 28.6 mm | 44.5 mm |

Suction Cups with Housing

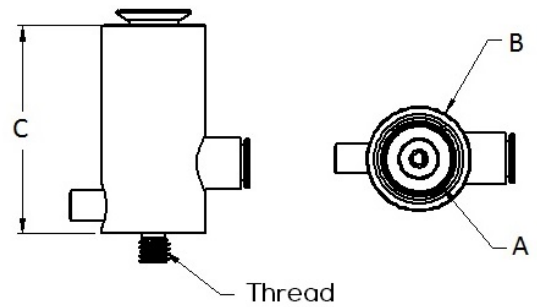

| Part Number | Thread | A | B | C | Inc. Angle |
|-------------|--------|-------|---------|---------|------------|
| R20-5-VSC | 1/4-20 | 5 mm | 0.438" | 1.46" | 90° |
| R20-10-VSC | 1/4-20 | 10 mm | 0.75" | 1.875" | 120° |
| R20-15-VSC | 1/4-20 | 15 mm | 1" | 1.95" | 120° |
| R20-20-VSC | 1/4-20 | 20 mm | 1.25" | 2" | 120° |
| R20-30-VSC | 1/4-20 | 30 mm | 1.75" | 2.75" | 120° |
| R20-50-VSC | 1/4-20 | 50 mm | 1.75" | 3" | 120° |
| R8-10-VSC | M8 | 10 mm | 19 mm | 50.8 mm | 120° |
| R8-20-VSC | M8 | 20 mm | 31.8 mm | 50.8 mm | 120° |
| R8-30-VSC | M8 | 30 mm | 44.5 mm | 75 mm | 120° |
| R8-50-VSC | M8 | 50 mm | 44.5 mm | 75 mm | 120° |
| R6-5-VSC | M6 | 5 mm | 11.1 mm | 37 mm | 90° |
| R6-10-VSC | M6 | 10 mm | 19 mm | 37 mm | 120° |
| R6-15-VSC | M6 | 15 mm | 23.8 mm | 50.8 mm | 120° |
| R6-20-VSC | M6 | 20 mm | 31.8 mm | 50.8 mm | 120° |
| R6-30-VSC | M6 | 30 mm | 44.5 mm | 75 mm | 120° |
| R6-50-VSC | M6 | 50 mm | 44.5 mm | 75 mm | 120° |
| R4-5-VSC | M4 | 5 mm | 11.1 mm | 37 mm | 90° |
| R4-10-VSC | M4 | 10 mm | 19 mm | 50.8 mm | 120° |
| R4-15-VSC | M4 | 15 mm | 23.8 mm | 50.8 mm | 120° |
| R4-20-VSC | M4 | 20 mm | 31.8 mm | 50.8 mm | 120° |

V-Suction Cups with Housing

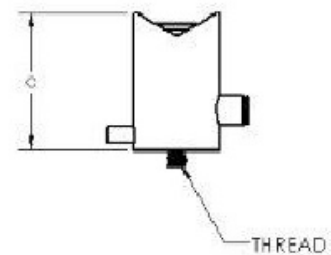
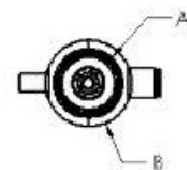

Exposed Suction Cups

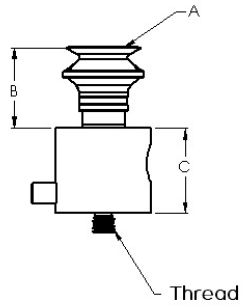

| Part Number | Thread | A | B | C |
|-------------|--------|-------|---------|---------|
| R20-10-EXSC | 1/4-20 | 10 mm | 0.85" | 1" |
| R20-20-EXSC | 1/4-20 | 20 mm | 0.96" | 1" |
| R20-30-EXSC | 1/4-20 | 30 mm | 1.365" | 1" |
| R20-50-EXSC | 1/4-20 | 50 mm | 1.72" | 1" |
| R8-10-EXSC | M8 | 10 mm | 21.6 mm | 25.4 mm |
| R8-20-EXSC | M8 | 20 mm | 24.4 mm | 25.4 mm |
| R8-30-EXSC | M8 | 30 mm | 34.7 mm | 25.4 mm |
| R8-50-EXSC | M8 | 50 mm | 43.7 mm | 25.4 mm |
| R6-10-EXSC | M6 | 10 mm | 21.6 mm | 25.4 mm |
| R6-20-EXSC | M6 | 20 mm | 24.4 mm | 25.4 mm |
| R6-30-EXSC | M6 | 30 mm | 34.7 mm | 25.4 mm |
| R6-50-EXSC | M6 | 50 mm | 43.7 mm | 25.4 mm |

Slide Suction Cups

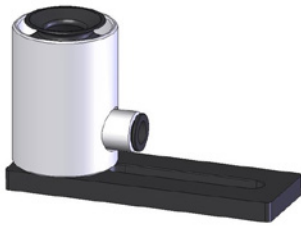

| Part Number | Thread | A | B | C | D | E |
|-------------|--------|---------|-------|---------|-------|---------|
| R20-10-SSC | 1/4-20 | 1" | 10 mm | 0.75" | 2" | 3" |
| R20-15-SSC | 1/4-20 | 1" | 15 mm | 0.875" | 2" | 3" |
| R20-20-SSC | 1/4-20 | 1" | 20 mm | 1.125" | 2" | 3" |
| R8-10-SSC | M8 | 25.4 mm | 10 mm | 19 mm | 50 mm | 76.2 mm |
| R8-15-SSC | M8 | 25.4 mm | 15 mm | 22.2 mm | 50 mm | 76.2 mm |
| R8-20-SSC | M8 | 25.4 mm | 20 mm | 28.6 mm | 50 mm | 76.2 mm |
| R6-10-SSC | M6 | 25.4 mm | 10 mm | 19 mm | 50 mm | 76.2 mm |
| R6-15-SSC | M6 | 25.4 mm | 15 mm | 22.2 mm | 50 mm | 76.2 mm |
| R6-20-SSC | M6 | 25.4 mm | 20 mm | 28.6 mm | 50 mm | 76.2 mm |

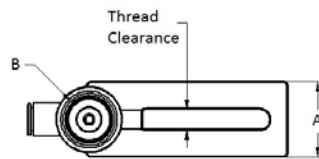
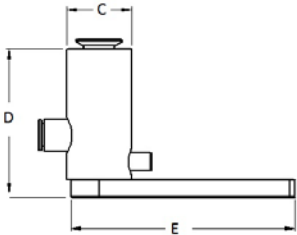

Square V-Suction Cups



| Part Number | Thread | A | B | C | D | Inc. Angle |
|-------------|--------|----------|---------|-------|---------|------------|
| R20-20-SVSC | 1/4-20 | 5" | 1.875" | 20 mm | 3" | 120° |
| R20-50-SVSC | 1/4-20 | 6" | 3.5" | 50 mm | 3" | 150° |
| R8-20-SVSC | M8 | 127 mm | 48.2 mm | 20 mm | 76.2 mm | 120° |
| R8-50-SVSC | M8 | 152.4 mm | 88.9 mm | 50 mm | 76.2 mm | 150° |
| R6-20-SVSC | M6 | 127 mm | 48.2 mm | 20 mm | 76.2 mm | 120° |
| R6-50-SVSC | M6 | 152.4 mm | 88.9 mm | 50 mm | 76.2 mm | 150° |

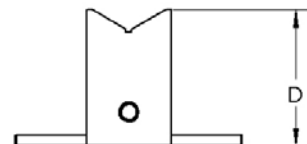
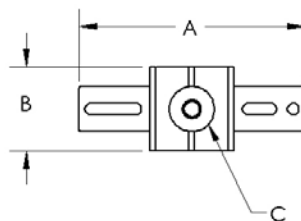

| Part Number | Description |
|-------------|----------------------------------------------|
| R-X10L | X10L Vacuum Pump, 1/8" Male Quick Disconnect |
| R-9P-M | 9 Port Manifold |
| R-13P-M | 13 Port Manifold |
| R-12-VH | Vacuum Hose, 12" Long |
| R-18-VH | Vacuum Hose, 18" Long |
| R-24-VH | Vacuum Hose, 24" Long |
| R-36-VH | Vacuum Hose, 36" Long |
| R-60-VH | Vacuum Hose, 60" Long |
| R-120-VH | Vacuum Hose, 120" Long |
| R-PMC1002 | Open Coupler |
| R-PMCD1002 | Closed Coupler |
| R-PMCD2202 | Straight Hose Barb |
| R-PMC2302 | Elbow Hose Barb |

Vacuum Accessories

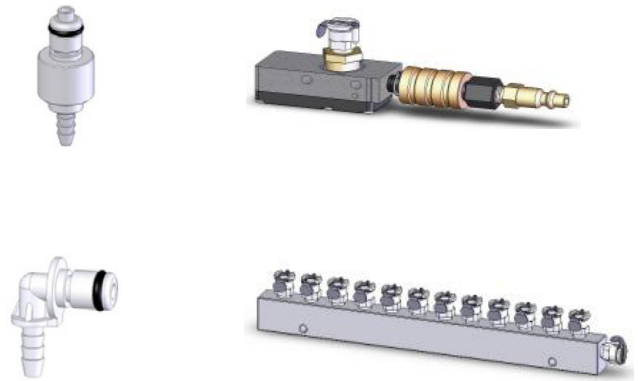

| Part Number | Description |
|-------------|----------------------------------------|
| R20-DK-45 | 1/4-20 x 5/8 SHCS with Thumb Screw Cap |
| R20-HDS-L | 1/4-20 Threaded Hold Down Screw Large |
| R20-HDS-S | 1/4-20 Threaded Hold Down Screw Small |
| R20-AS | 1/4-20 Adapter Screw |
| R8-AS | M8 Threaded Adapter Screw |
| R8-HDS-L | M8 Threaded Hold Down Screw |
| R6-DK-45 | M6 x 16 mm SHCS with Thumb Screw Cap |
| R6-HDS-L | M6 Threaded Hold Down Screw Large |
| R6-AS | M6 Threaded Adapter Screw |
| R4-AS | M4 Threaded Adapter Screw |

Screws & Mounting Pins



| Part Number | Description |
|-------------|----------------------------------------|
| R20-SCT | Small Component Tray for 1/4-20 Thread |
| R20-LCT | Large Component Tray for 1/4-20 Thread |
| R8-SCT | Small Component Tray for M8 Thread |
| R8-LCT | Large Component Tray for M8 Thread |
| R6-SCT | Small Component Tray for M6 Thread |
| R6-LCT | Large Component Tray for M6 Thread |
| R4-MCT | Mini Component Tray for M4 Thread |
| AX-BOX | Organizer Box |
| R-CASE-B | Case for Clamping Kit B (1 Layer) |
| R-CASE-C | Case for Clamping Kit C (2 Layer) |
| R-VCT | Vacuum Component Tray |

Component Trays & Cases



AX Kits: Aluminum Extrusions



AX-KIT-3

| Part Numbers | Description | AX-KIT-1 | AX-KIT-2 | AX-KIT-3 |
|-------------------------|---------------------------------------------------|-----------|------------|------------|
| AX-16 | 1" x 1" x 6" Arm | 2 | 2 | 4 |
| AX-112 | 1" x 1" x 12" Arm | | | 2 |
| AX-1212 | 1" x 2" x 12" Arm | 1 | 2 | |
| AX-126 | 1" x 2" x 6" Arm | | | 2 |
| AX1-2-12 | 1" x 2" x 12" Arm | | | 4 |
| AX-218 | 2" x 2" x 18" Arm | 1 | 1 | 3 |
| AX-224 | 2" x 2" x 24" Arm | 2 | 2 | 4 |
| AX-230: | 2" x 2" x 30" Arm | | | 2 |
| AX-236 | 2" x 2" x 36" Arm | | 2 | 4 |
| AX-242 | 2" x 2" x 42" Arm | | | 2 |
| AX20-2AF | 2" W. Angle Foot To Base Plate with 1/4-20 Thread | 4 | 6 | 16 |
| AX-2AB4 | 2" W. Angle Bracket with 4 Holes | 2 | 2 | 8 |
| AX-2AG8 | 2" Angle with 8 Holes | 2 | 2 | 6 |
| AX-1AG4 | 1" Wide Angle Gusset with 4 Holes | 2 | 2 | 4 |
| AX-2AG8 | 2" Wide Angle Gusset with 8 Holes | 2 | 2 | 12 |
| AX-21AT6 | 2" Wide Angle Transition with 6 Holes | 1 | 2 | 6 |
| AX-JP8 | 2" Wide Joining Plate with 8 Holes | | | 4 |
| AX-12AB | 12" Angle Brace | | 2 | 4 |
| AX-15AB | 15" Angle Brace | | | 2 |
| AX20-33 | 3" x 3" x 1/2" Grid Plate, 1/4-20 Threaded Holes | 2 | 4 | 8 |
| AX20-36 | 3" x 6" x 1/2" Grid Plate, /4-20 Threaded Holes | 1 | 3 | 6 |
| AX-1-C | 1" sq. End Cap | 2 | 2 | 4 |
| AX-12-C | 1" x 2" End Cap | 1 | 2 | 6 |
| AX-2-C | 2" sq. End Cap | 4 | 6 | 16 |
| AX-NUT | T-Nut | 86 | 100 | 320 |
| AX-PVNUT | Pivot T-Nut | 8 | 12 | 32 |
| AX-BOX | Organizer Box | 1 | 1 | 1 |
| Total Components | | 39 | 155 | 482 |

Extrusion Accessories

| Part Number | Description |
|-------------|-------------------|
| AX-16 | 1" sq x 6" Arm |
| AX-112 | 1" sq. x 12" Arm |
| AX-126 | 1" x 2" x 6" Arm |
| AX-1212 | 1" x 2" x 12" Arm |
| AX-1218 | 1" x 2" x 18" Arm |
| AX-1224 | 1" x 2" x 24" Arm |
| AX-26 | 2" sq. x 6" Arm |
| AX-218 | 2" sq. x 18" Arm |
| AX-224 | 2" sq. x 24" Arm |
| AX-230 | 2" sq. x 30" Arm |
| AX-236 | 2" sq. x 36" Arm |
| AX-242 | 2" sq. x 42" Arm |
| AX-248 | 2" sq. x 48" Arm |
| AX-260 | 2" sq. x 60" Arm |
| AX-324 | 3" sq. x 24" Arm |
| AX-336 | 3" sq. x 36" Arm |
| AX-348 | 3" sq. x 48" Arm |
| AX-360 | 3" sq. x 60" Arm |

Arms

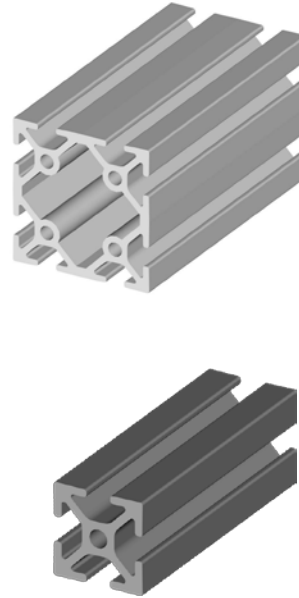

| Part Number | Description |
|-------------|-------------|
| AX-NUT | T-Nut |
| AX-3NUT | T-Nut |
| AX-PVNUT | Pivot T-Nut |

T-Nuts

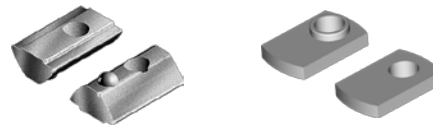

| Part Number | Description |
|-------------|---------------------------------------------------|
| AX20-2AF | 2" Wide Angle Foot to Base Plate (1/4-20 Threads) |
| AX8-2AF | 2" Wide Angel Foot to Base Plate (M8 Threads) |

Angle Foot



| Part Number | Description |
|-------------|-----------------------------|
| AX-JP6 | Joining Plate with 6 Holes |
| AX-JP8 | Joining Plate with 8 Holes |
| AX-JP12 | Joining Plate with 12 Holes |

Joining Plate

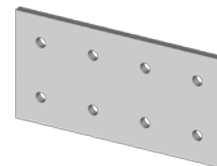

| Part Number | Description |
|-------------|------------------------------------|
| AX-1AB4 | 1" Wide Angle Bracket with 4 holes |
| AX-2AB4 | 2" Wide Angle Bracket with 4 holes |
| AX-2AB6 | 2" Wide Angle Bracket with 6 Holes |
| AX-2AB8 | 2" Wide Angle Bracket with 8 Holes |
| AX-2AB8 | 2" Wide Angle Bracket with 8 Holes |

Angle Bracket



Angle Brace



| Part Number | Description |
|-------------|-----------------|
| AX-12AB | 12" Angle Brace |
| AX-15AB | 15" Angle Brace |
| AX-18AB | 18" Angle Brace |

Angle Gusset



| Part Number | Description |
|-------------|-----------------------------------|
| AX-1AG4 | 1" Wide Angle Gusset with 4 holes |
| AX-2AG4 | 2" Wide Angle Gusset with 4Holes |
| AX-2AG8 | 2" Wide Angle Gusset with 8 Holes |
| AX-3AG4 | 3" Wide Angle Gusset with 4 Holes |
| AX-3AG8 | 3" Wide Angle Gusset with 8 Holes |

Angle Transition

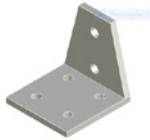

| Part Number | Description |
|-------------|----------------------------------|
| AX-21A6 | 2" Angle Transition with 6 Holes |
| AX-23A8 | 2" Angle Transition with 8 Holes |

Grid Plate



| Part Number | Description |
|-------------|-----------------------------------------------------------|
| AX20-33 | 3" x 3" x 1/2" Aluminum Plate with 1/4-20 Threaded Holes |
| AX20-36 | 3" x 6" x 1/2" Aluminum Plate with 1/4-20 Threaded Holes |
| AX8-9090 | 90mm x 900mm x 13mm Aluminum Plate with M8 Threaded Holes |
| AX8-90165 | 90mm x 165mm x 13mm Aluminum Plate with M8 Threaded Holes |

End Caps

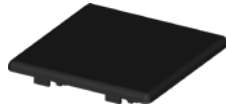

| Part Number | Description |
|-------------|-----------------|
| AX-1-C | 1" x 1" End Cap |
| AX-12-C | 1" x 2" End Cap |
| AX-2-C | 2" x 2" End Cap |
| AX-3-C | 3" x 3" End Cap |

Rotating Base

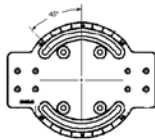

| Part Number | Description |
|-------------|-------------------------|
| AX20-RB | 5" x 5" Rotational Base |

Top Plate

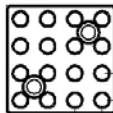

| Part Number | Description |
|-------------|--------------------------|
| AX20-TP | 2" x 2" x 1/2" Top Plate |

Case



| Part Number | Description |
|-------------|---------------|
| AX-BOX | Organizer Box |

Screws

| Part Number | Description |
|-------------|------------------------------|
| AX20-BH-50 | 1/4-20 Button Head Cap Screw |
| AX20-BH-63 | 1/4-20 Button Head Cap Screw |
| AX8-BH | M8 Button Head Cap Screw |
| AX20-SH-50 | 1/4-20 Socket Head Cap Screw |
| AX20-SH-63 | 1/4-20 Socket Head Cap Screw |
| AX8-SH | M8 Socket Head Cap Screw |

PLATE DIMENSIONS AND MOUNTING HOLE LOCATIONS

MACHINE: _____

PLATE MATERIAL: _____

FINISH: _____

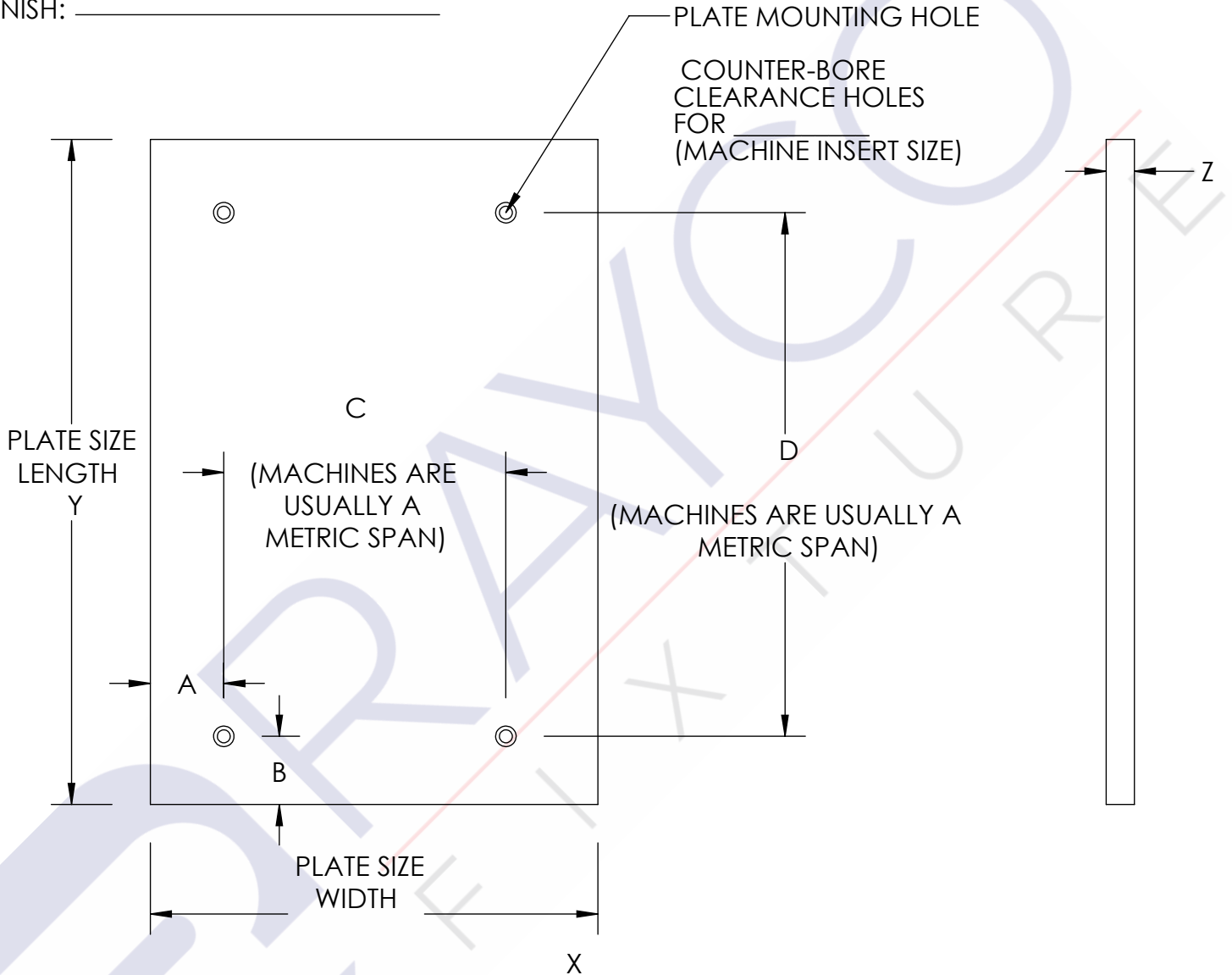

X: _____ PLATE WIDTH

Y: _____ PLATE LENGTH

Z: _____ PLATE THICKNESS

A: _____ DISTANCE FROM PLATE LEFT EDGE TO 1ST MOUNTING HOLE

B: _____ DISTANCE FROM PLATE BOTTOM EDGE TO 1ST MOUNTING HOLE

C: _____ SPAN OF BETWEEN MOUNTING HOLES IN PLATE X

D: _____ SPAN BETWEEN MOUNTING HOLES IN PLATE Y

MICRON MEASUREMENT TECHNOLOGY

Authorized Distributor

For price quotes, lead times, or questions regarding custom-made CMM and VMM fixture plates and accessories, please contact:

Phone: (828) 391-9710

Email: support@micronmeasurement.com

Website: www.MicronMeasurement.com

Business Hours:

Monday – Thursday: 9:00 AM – 4:30 PM EST

Friday – Sunday: Closed

Serving Industrial, Manufacturing, and Quality Control Professionals

